

**DOCK FENDER**

Can be easily formed to cover corners and bends. Will not deteriorate in the sun, will not mark the boat. Available as a pair.

Code	Length m	Width mm	Height mm
<b>4215</b>	<b>1</b>	<b>140</b>	<b>60</b>
<b>4215 -1</b>	<b>0,94</b>	<b>85</b>	<b>44</b>

**737-1****737-2****DOCK FENDERS – BUMPER**

The dock fenders are made of rotomolded P.V.C. with reinforced and closed holes. Manufactured for being resistant to extreme sea conditions, high abrasion and sun resistance. The dock fender is an important "bumper" that can be mounted to provide added protection to both the boat and dock. Normal inflation measurements pressure 0,15 bar at approximate 20° C temperature.

Code	Description	Length cm	Width cm	Weight Kg	Color
<b>737-1W</b>	Right angle	88,5	27	6	White
<b>737-1BL</b>					Blue
<b>737-2W</b>	C-shape to be mounted on docks with rubber or wooden edge				White
<b>737-2BL</b>					Blue

**STERN FENDER FOR SAILING BOAT**

Code	Diameter cm	Height cm
<b>737</b>	<b>10</b>	<b>22</b>

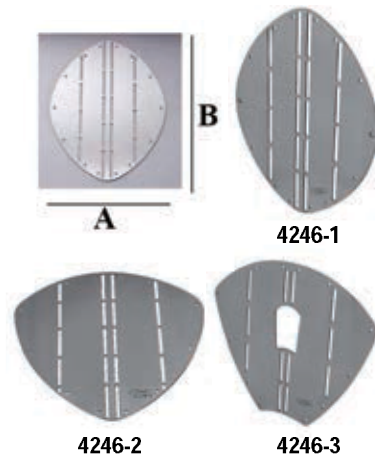
**4246-1****4246-2****4246-3****BOW SHIELD PROTECTION**

Stainless steel.

Code	Dimensions mm		Thickness mm	Weight Kg
	A	B		
<b>4246-1</b>	265	345	1,5	0,70
<b>4246-2</b>	350	345	1,5	0,95
<b>4246-3</b>	320	270	1,5	0,70

**PLASTIC UTILITY DEVICE FOR TYING**

An utility plastic device specially constructed to facilitate tying to cleats and bollards. A rope (with thickness up to 18 mm) can be placed on the guides to the outer side of the device that has an open loop and flexibility to adjust to the size of the cleat or bollard. Pass the loop of the device on the cleat or bollard and then pull it. The rope remains in the desired position.



Code	Dimensions mm	Aluminum pole Length cm
<b>4928</b>	<b>L 320 x W 21,5</b>	<b>167</b>

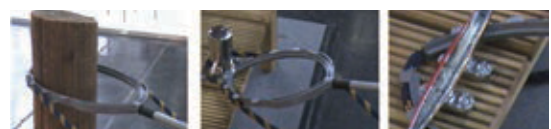



#### PLASTIC UTILITY DEVICE FOR TYING

Plastic hook with aluminium tube to fit in a standard or telescopic pole / handle. It features an automatic device to surround a ring or cleat with a rope attached to a fixture on the end of the device. Available either by itself (code 4929) and it can be combined with aluminum telescopic pole code. 4944 or with in-built aluminum telescopic pole (code 4965).

4965



Code	Dimensions cm	Description
4929	L 24 x Ø2,5	Without aluminum pole
4965	L 120-220 x Ø2,5	With aluminium telescopic pole of 120 cm (closed) 220 cm (opened) length



755-Y

**NEW**

#### RIGID MARKER BUOYS – BICONICAL

Rigid biconical buoys made of polyethylene. They are specially designed for marking and mooring. They are molded in just one piece with uniform wall thickness, smooth surface and durable ropeholds.

755-O

Code	Diameter cm	Height cm	Buoyancy kg	Color
755-O	52	107	61	Orange
755-Y				Yellow



#### BICONICAL BUOYS EVAL

Plastic, made of blow pressed polyethylene with plastic handle.

Code	Length mm	Ø mm	Weight gr
760 - Orange	700	320	1100
760 - Yellow			

#### INFLATABLE BUOYS

Inflatable buoys made of high quality PVC with strong rope eye, rod and swivel made of hot dipped galvanized steel. They have uniform wall thickness with smooth surface and glossy finish. Manufactured for being resistant to extreme sea conditions, high abrasion and sun resistance. They have extra flexible body material and quality plastic valve to secure a perfect seal. Normal inflation measurements pressure 0,15 bar at approximate 20°C temperature.

**NEW**



Code	Color	Length cm	Total Length cm	Ø cm	Rod Ø mm	Buoyancy Kg	Weight Kg
4208-1		44	87	43		27	6,6
4208-2	Orange	55	90	52	18	55	8,2
4208-3		65	92	60		104	10,6



#### ALUMINUM POLE

It can be combined with code 4929

Code	Length cm		Diameter mm
	Opened	Closed	
4944	220	120	25



#### SOLID BUOYS EVAL

Code	Color	Length mm	Ø mm	Eye diam. mm
4204-2	Orange	600	285	16

#### PEAR SHAPED BUOYS EVAL

Plastic, suitable for signaling in docking and fishing.



Code	Length mm	Ø mm	Weight gr
3176 - Orange	377	203	270
3176 - Yellow			
765 - Orange	420	250	470
765 - Yellow			



#### BICONICAL BUOYS

Plastic, made of blow pressed polyethylene with galvanized center shaft. With polyurethane foam.



Code	Length mm	Ø mm	Weight gr
761 - Orange	700	320	2400



#### GALVANIZED STEEL ROD MOORING BUOY

Rigid plastic skin with a Urethane foam core double cone. Galvanized Steel rod mooring buoys.



Code	Diameter cm	Height cm	Buoyancy kg	Color
917	52	103	58	Red



#### INFLATED BUOYS

Code	Color	Length mm	Ø mm	Eye diam mm
4205-1	Red	640	385	16
4205-2	Red	740	450	19
4205-3	Red	855	590	19



## MOTOR EQUIPMENT



- Fuel Canisters / Portable Fuel Tanks
- Fixed Fuel & Water Tanks
- Tank Floaters
- Hoses / Fuel Primer Bulbs
- Water & Fuel Plugs / Breathers
- Trim Tabs / Filters & Water Separators
- Steering Wheels / Consoles
- Steering Systems / Steering Cables
- Lever Controls
- Engine Control Cables
- Steering Gromets
- Hydrofoils
- Auxiliary Outboard - Brackets
- Motor Extension Handles
- Transom Pads
- Engine Connectors
- Motor Washers
- Propellers
- Marine Oils

155-212



### FUEL CANISTERS

Approved. Made in accordance to the most severe safety requirements. Includes flexible filler.

Code	Volume lt	Type
4318 - 5	5	With view strip on the side
4318 - 10	10	

Code	Volume lt
4318 - 20	20



### CANISTERS

Made of special row material approved, polyethylene, antiexplosive. Includes flexible filler code 831.

Code	Capacity lt	Color	Type
814-15	15	ORANGE	FOR FUEL
814-22	22	ORANGE	FOR FUEL
814-22 WHITE	22	WHITE	FOR WATER



### FUEL TANK WITH FLOAT

Made of tough and unburned polyethylene for the safest possible transfer of the fuel minimizing the possibility of inflammation.

Code	LT	Dimensions cm
820 - 22-1	22	L 45 x W 31 x H 26
820 - 30-1	30	L 49 x W 33 x H 27



### FUEL TANKS CE APPROVED

Made of tough and unburned polyethylene, guarantees the safest possible transfer of the fuel minimizing the possibility of inflammation. CE Approved by HEEQAC, Test Report 503363.

Code	LT	Dimensions cm
820 - 12	12	L 39 x W 26 x H 22
820 - 22	22	L 45 x W 31 x H 26
820 - 30	30	L 49 x W 33 x H 27



#### Code 834 FILLER CAP

For tanks 814-15, 814-22 and fuel tanks 820-12, 820-22, 820-30, 820-22-1, 820-30-1.

#### Code 831 CANISTER EXTENSION

Plastic, for codes 814-15, 814-22, 820-12, 820-22, 820-30, 820-22-1, 820-30-1.

#### Code 833 PIPE

For tank 820-12, 820-22, 820-30, 820-22-1, 820-30-1. At the lower end it has a filter

#### Code 865 PLASTIC HOSE

Plastic hose ¼ for Ø8 tube. For code 833





FUEL TANKS

Code	LT	Dimensions cm
<b>2912 - 42</b>	43	L65 x W35 x H23
<b>2912 - 52</b>	53	L80 x W35 x H23
<b>2912 - 75</b>	70	L80 x W40 x H28



FUEL TANKS

Code	LT	Dimensions cm
<b>823 - 40</b>	42	L50 x W35 x H30
<b>823 - 51</b>	55	L65 x W35 x H30
<b>823 - 65</b>	70	L80 x W35 x H30

4540 - 1    4540 - 2    4540 - 3  
Suitable for all CAN tanks

Code	Discription	Diameter mm
<b>4540 - 1</b>	Connectors for fuel	10/12
<b>4540 - 2</b>	and water tanks	17/19
<b>4540 - 3</b>	Racor plug suitable for water tanks	9,6



FUEL TANKS

Code	LT	Dimensions cm
<b>2916 - 75</b>	75	L 105 x W 35 x H 22+5



FUEL TANKS

Code	LT	Dimensions cm
<b>4536 - 73</b>	57	L 65 x W 40 x H 30
<b>4536 - 103</b>	78	L 90 x W 40 x H 30
<b>4537 - 73</b>	57	L 65 x W 30 x H 40
<b>4537 - 103</b>	78	L 90 x W 30 x H 40

**Code 627**  
**FOUR BRACKET SET**  
Made of plastic, includes polypropylene straps + tank locking buckle, fender and others, universal model.

FIXED FUEL TANK "V" SHAPE



Code	LT	Diameter Inlet Pipe mm	Diameter Breather mm	Dimensions cm
<b>2917 - 100</b>	100	38	16	L 133 x W 60 x H 25+7
<b>2917 - 150</b>	150	38	16	L 126 x W 71 x H 25+7



FIXED FUEL TANKS FLAT BOTTOM

Code	LT	Diameter Inlet Pipe mm	Diameter Breather mm	Dimensions cm
<b>2918 - 90</b>	90	38	16	L 78 x W 76,5 x H 20,5+7



FIXED FUEL TANKS FLAT BOTTOM

Code	LT	Diameter Inlet Pipe mm	Diameter Breather mm	Dimensions cm
<b>2918 - 200</b>	200	38	16	L 120 x W 64 x H 32+5

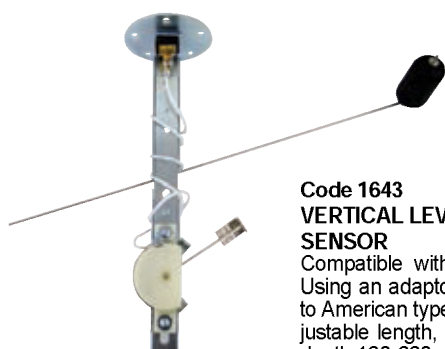

**Code 1643  
VERTICAL LEVEL  
SENSOR**

Compatible with EU type 10/189 Ω. Using an adaptor it can be connected to American type 240/30Ω as well. Adjustable length, suitable for tanks with depth 130-660 mm



**Code 4453  
FUEL LEVEL SENSOR - FUEL LEVEL GAUGE  
ADAPTOR**

It is used to make compatible with each other different impedances. For example, it is able to connect a 10/180Ω ( European type) level sensor with a 240/30Ω (American type) fuel level gauge.



**VERTICAL LEVEL SENSOR**

Electrical and stainless steel. Vertical application Compatible with EU type 10/189 Ω. Using an adaptor it can be connected to American type 240/30Ω as well. Suitable for water as well.

Code	Length cm
1645 - 17	17
1645 - 20	20
1645 - 22	22
1645 - 25	25
1645 - 30	30
1645 - 33	33
1645 - 40	40
1645 - 45	45
1645 - 50	50
1645 - 55	55



**FITTINGS FOR FUEL/WATER TANKS**

They are suitable for the tanks with codes : 820-22-1,820-30-1,820\*,2916-75,4536\*,4537\*,2918\*,2917\*.

Code	Description	Thread	Internal connection diameter mm
3141-5	Breather pipe for all fuel/water tanks	1/4"	12
3141-6	Outlet pipe for all fuel/water tank breather	1/4"	10

**PLASTIC ENTRY FOR FUEL AND WATER TANKS**

Code	Internal connection diameter	Type	Thread Intern. Diamet. Inch
3141	38/50/60	Straight and Angled	1-1/2"
3141 - 1	38	Angled	1-3/4"
3141 - 2	38/50/60	Straight	for code 2916-75, 4536-103, 4536-73, 4537-103, 4537-73, 4539-103, 4539-73 2-3/16 "
3141 - 3	50	Angled	for code 2916-75, 4536-103, 4536-73, 4537-103, 4537-73, 4539-103, 4539-73 2-3/16 "
3141 - 4	35	Angled	2-3/16 "



3141

**WATER TANKS**

Code	LT	Dimensions cm
<b>2937 - 45</b>	47	L45 x W39 x H29
<b>2937 - 56</b>	57	L55 x W39 x H29

**WATER TANKS**

Code	LT	Dimensions cm
<b>2920 - 52</b>	52	L75 x W39 x H20
<b>2920 - 75</b>	71	L105 x W39 x H20

**WATER TANKS**

Code	LT	Dimensions cm
<b>4538 - 73</b>	70	L66 x W41 x H30+3
<b>4538 - 103</b>	100	L91 x W41 x H30+3

**WATER TANKS**

Code	LT	Dimensions cm
<b>2937 - 70</b>	70	L66 x W30 x H41
<b>2937 - 100</b>	100	L91 x W30 x H41

**WATER TANKS**

Code	LT	Dimensions cm
<b>4539 - 73</b>	73	L65 x W30 x H40
<b>4539 - 103</b>	103	L90 x W30 x H40

**FLEXIBLE WATER TANK****RECTANGULAR**

With each tank are available a plastic fitting, for tank filling and for tank emptying.

Code	LT	Dimensions cm
<b>2375-2</b>	100	L 74 x W 90
<b>2375-3</b>	120	L 74 x W 100
<b>2375-4</b>	150	L 74 x W 125
<b>2375-5</b>	210	L 74 x W 175

**NEW****FLEXIBLE WATER TANK - TRIANGULAR**

With each tank are available a plastic fitting, for tank filling and for tank emptying.

Code	LT	Dimensions cm
<b>2380 - 1</b>	55	L 95 x W 76
<b>2380 - 2</b>	100	L 105 x W 92

**FLEXIBLE WATER TANKS**

Flexible water tanks in elastomer thermoplastic of great durability. Available with flange and complete set of connection fittings required for the function. Rectangular or triangular shape.

Code	Capacity lt	Dimensions mm			Shape
		A	B	C	
<b>2383-1</b>	60	730	730		■
<b>2383-2</b>	75	770	730		■
<b>2383-3</b>	100	880	730		■
<b>2383-4</b>	120	1030	730		■
<b>2383-5</b>	150	1150	730		■
<b>2383-6</b>	55	950	1000	130	▲
<b>2383-7</b>	100	1100	1100	250	▲

**SHUT OF WATER VALVE**

Code	Output Diameter mm	Thread	Height
<b>2393</b>	15	24 mm	88 mm





### QUICK PLASTIC CONNECTORS

Suitable for compressed air network and hydraulic networks. Very easy installation due to the quick release patent



**CONNECTOR STRAIGHT**

Code	Diameter mm
<b>4886</b>	12



**CONNECTOR MALE**

Code	Diameter mm	Thread inch
<b>4891</b>	12	1/2"



**CONNECTOR UNION «T» TYPE**

Code	Diameter mm
<b>4887</b>	12



**CONNECTOR FEMALE**

Code	Diameter mm	Thread inch
<b>4894</b>	12	3/8"



**CONNECTOR UNION ELBOW 90° MALE**

Code	Diameter mm	Thread inch
<b>4893</b>	12	3/8"



**CONNECTOR UNION ELBOW 90°**

Code	Diameter mm
<b>4888</b>	12



**CONNECTOR UNION ELBOW 90° MALE**

Code	Diameter mm	Thread inch
<b>4892</b>	12	1/2"



**CONNECTOR FEMALE**

Code	Diameter mm	Thread inch
<b>4895</b>	12	1/2"



**CONNECTOR MALE**

Code	Diameter mm	Thread inch
<b>4890</b>	12	3/8"



**POLYETHYLENE REINFORCED TUBE**

Code	Internal Diam. mm	External Diam. mm	Type
<b>4899-BLUE</b>	10	12	For cold water
<b>4899-RED</b>	10	12	For hot water



**CONNECTOR FEMALE «Y» TYPE**

Code	Diameter mm
<b>4889</b>	12

**PLASTIC PLUGS EVAL**

Plastic Deck Plugs EVAL for filling water and fuel with large cap, blue for water and red for fuel, and with chain in order to avoid its loss.

Code	Internal tube Ø	Color
3153 - Water	38	Blue
3153 - Fuel		Red
3153 - Water		Chrome
3153 - Fuel		Chrome



Code 4502

**KEY FOR PLUGS**  
Made of stainless steel.

**STAINLESS STEEL PLUG**

Vented stainless steel plug, angled 30°

Code	Internal tube Ø
989 - Water	38
989 - Fuel	
989 - 50 - Fuel	50

**NYLON PLUG**

Vented plastic plug, angled 30° with stainless steel cup with integrated spring to prevent loss.

Code	Internal tube Ø
1017 - Water	38
1017 - Fuel	

**STAINLESS STEEL PLUG**

With ring nut and chain to avoid its loss.

Code	Internal tube Ø
930 - Water	38
930 - Fuel	
930-Waste	50
930 -50 - Fuel	

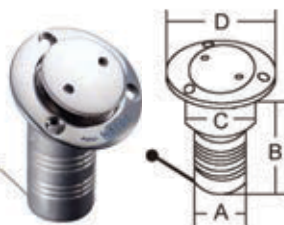
**POP OUT DECK FILL 30 DEGREE**

Stainless Steel 316. It has key-less pop out cap with spring loaded security cable. Color-coded international symbol with engraved lettering.

Code	Angle°	A mm	B mm	C mm	D mm
938 - Water	30°	38	90	45	76
938 - Fuel					

**FUEL PLUG STAINLESS STEEL WITH KEY**

Heavy duty stainless steel fuel plug with key and protection cup.

Code	Internal tube Ø
1628	38
1628 - 50 - Fuel	50

**STAINLESS STEEL PLUG**

Vented plastic plug, straight, with integrated spring to prevent loss.

Code	Internal tube Ø
988 - Water	38
988 - Fuel	
988 - 50 - Fuel	50

**STAINLESS STEEL PLUG**

Stainless steel with recessed handle for screwing / unscrewing.

Code	Internal tube Ø
933 - Water	38
933 - Fuel	
933 -50 - Fuel	50

**ANGLED FUEL PLUG**

Stainless steel with recessed handle for screwing / unscrewing.

Code	Internal tube Ø
3040 - Water	38
3040 - Fuel	
3040 -50 - Fuel	50



Code 1044  
**STAINLESS STEEL FUEL TANK BREATHER 90°**  
Internal tube Ø 14,3 mm.



Code 1049  
**CHROMED BRASS FUEL TANK BREATHER**  
Internal tube Ø 14,5 mm.



Code 947  
**CHROMED BRASS FUEL TANK BREATHER 90°**  
Internal tube Ø 14,3 mm

### ELASTIC HOSES

Suitable for diesel and fuel, for pleasure craft inboard engines up to 24 m. With textile reinforcement. In accordance to EN ISO 7840-A1-1994 and approved by RINA CE 0474.

Temperature range: -25° C / + 120° C.  
"With steel wire helix reinforcement"

Code	Internal tube Ø mm
1756 - 38	38
1756 - 50	51



### SPRAY STOP ANTI SPLASH TAPE

An IMO compliant solution to the risk of spray out from pipe flanges and the fuel system. It can also be used on hot water and steam systems. Quick and easy to apply. Coil wrap the tape around any joint or linkage in the fuel system. Recommended for all vessels. Made of multilayer aluminium/glasscloth coated material. Tensile strength 158 lbs and max pressure 20 bar.

Code	Dimensions m x cm
3865	L 10 x W 5



### RUBBER HOSES

Suitable for diesel and fuel, for outboard engines, with textile reinforcement and up to 40% aromatic NBR rubber. Temperature range: -20 C/ +80C

Code	Internal Diameter	External Diameter mm
841 - 08	8 mm	5/16" inch
843 - 07	7 mm	5/18" inch
841 - 10	10 mm	3/8" inch
841 - 15	15 mm	19/32" inch
841 - 19	19 mm	3/4" inch



### PIPE AND HOSE REPAIR KIT

Suitable for sealing leaks in water pipes, oil pipes, gas pipes and more. Works on virtually any surface: rubber, plastic, copper, steel. Ready in just 30 minutes. Finished repair can be sanded and painted. Pressures up to 20 Bar.

Code	Dimensions L m x W cm
4213 - 75	L 2,7 x W 7,5



### PVC HOSE

Suitable for diesel and fuel, for outboard engines.

Code	Internal Diameter	External Diameter mm
845	7 mm	5/18" inch

### HOSE MADE OF PVC

Suitable for suction and delivery of drinking water and alimentary liquids. Reinforced with steel wire helix. Standards: D.M. 21/3/73 and EEC dir. 90/128. Temperature range: -10o C / +60o C.



Code	Internal Diameter	Length m
1661 - 19	19 mm	3/4 inch
1661 - 25	25 mm	1 inch
1661 - 32	32 mm	1 1/4 inch
1661 - 38	38 mm	1 1/2 inch



### MARINE TOILET PVC HOSE

Extremely flexible designed sewage pipe for marine toilets. It has the advantage to limit the spreading of odours from the toilet drains. White PVC with steel wire helix reinforcement. Temperature range -15o C / +60o C.

Code	Internal Diameter	Length m
1662 - 19	19 mm	3/4 inch
1662 - 25	25 mm	1 inch
1662 - 38	38 mm	1 1/2 inch



**RUBBER FUEL TANK HOSE MADE OF P.V.C**  
Complete with primer bulb and set of clamps.

Code	Diam. mm	Length m
2915	8	2



**FUEL PRIMER BULB FOR 2 & 4 STROKE ENGINES**  
Complete with hose.



Code	Primer bulb	Internal hose	Length m
844	9,5	7	2



### FUEL PRIMER BULBS

Code	Internal tube Ø mm
840	8
842	9.5



4231



4232

### FUEL PRIMER BULBS

Code	Internal tube Ø mm
4231	8
4232	9.5



**STAINLESS STEEL CLIPS**

Code	Diameter mm
4464 - 08	8
4464 - 10	10
4464 - 12	12
4464 - 16	16
4464 - 18	18
4464 - 20	20
4464 - 25	24
4464 - 28	28
4464 - 32	32



Code 4408

**RUBBER CLAMP (Pair)**

Ideal for stowing or transporting tools. Can also be used as a pipe stand-off (do not use on exhaust pipes). Mounts easily with one bolt or screw and with the strap facing any direction. Holds object of 22-57mm diameter and up to 10 kgs.

**TIE WRAP FOR GENERAL USE**

White color.

Code	Dimensions mm
846 - 1	L 80 x W 2,5
846 - 2	L 200 x W 2,5
846 - 3	L 150 x W 3,6
846 - 4	L 200 x W 4,8
846 - 5	L 103 x W 4,8
846 - 6	L 200 x W 7,6
846 - 7	L 300 x W 7,6



Code 4409

**RUBBER CLAMP**

Ideal for holding fire extinguishers, oxygen cylinders, CO2 tanks and other equipment. Mounts easily with one bolt or screw and with the strap facing any direction. Holds object of 64-191mm diameter and up to 23 kgs.

**STAINLESS STEEL CLAMPS**

Better chemical resistance and longer life in aggressive environment.

Code	Diameter mm	Width mm	Thickness mm
4463 - 36	36-39	21	1
4463 - 40	40-43	21	1
4463 - 44	44-47	21	1
4463 - 48	48-51	21	1
4463 - 52	52-55	21	1
4463 - 56	56-59	21	1
4463 - 60	60-63	21	1
4463 - 64	64-67	21	1
4463 - 68	68-73	24	1,2
4463 - 74	74-79	24	1,2
4463 - 80	80-85	24	1,2
4463 - 86	86-91	24	1,2
4463 - 92	92-97	24	1,2
4463 - 98	98-103	24	1,2
4463 - 104	104 - 112	24	1,2

**STAINLESS STEEL CLIPS FOR HOSES**

Code	Diameter mm
372 - 06	6 - 16
372 - 08	8 - 22
372 - 14	14 - 27
372 - 16	16 - 38
372 - 27	27 - 51
372 - 39	39 - 63
372 - 52	52 - 76
372 - 65	65 - 89
372 - 77	77 - 101
372 - 90	90 - 114

### CONNECTORS FOR SUZUKI - CHRYSLER ENGINES



**Code 863**  
CONNECTOR  
FOR FUEL  
TANK - MALE



**Code 861**  
CONNECTOR  
FOR FUEL  
TANK - FEMALE  
Ø 9,2 mm



**Code 859**  
MALE CONNECTOR



**Code 860**  
ENGINE  
CONNECTOR  
FEMALE  
Ø 7,8 mm

### CONNECTORS FOR TOHATSU - SELVA - NISSAN ENGINES



**Code 821**  
FEMALE  
CONNECTOR  
SELVA  
Ø 8mm



**Code 822**  
MALE  
CONNECTOR  
SELVA  
Ø 8mm

### CONNECTORS FOR HONDA ENGINES



**Code 863**  
CONNECTOR  
FOR FUEL  
TANK - MALE



**Code 861**  
CONNECTOR  
FOR FUEL  
TANK - FEMALE  
Ø 9,2 mm



**Code 824**  
FEMALE  
CONNECTOR  
HONDA F-LS  
Ø 8 mm



**Code 825**  
MALE CONNECTOR  
HONDA L-LM



**Code 978**  
FEMALE CONNECTOR FOR  
HONDA ENGINES  
Ø 9,8 mm

CONNECTORS FOR OMC - JOHNSON - EVINRUDE ENGINES



Code 848  
CONNECTOR  
FOR FUEL  
TANK - MALE



Code 849  
FEMALE  
CONNECTOR  
Ø 10 mm



Code 850  
ENGINE  
CONNECTOR  
MALE WITH  
VALVE  
Ø 7 mm



Code 862-1  
CONNECTOR FOR  
FUEL TANK - MALE  
Solid machined brass

CONNECTORS FOR YAMAHA - MARINER - MERCURY - SAIL I - PARSUN ENGINES



Code 852  
CONNECTOR  
FOR FUEL  
TANK - MALE



Code 853  
FEMALE  
CONNECTOR  
Ø 10,8 mm



Code 854  
ENGINE  
CONNECTOR  
MALE  
Ø 8,5 mm



Code 862-2  
CONNECTOR FOR  
FUEL TANK - MALE  
Solid machined brass

CONNECTORS FOR MARINER - MERCURY ENGINES



Code 855  
MALE  
CONNECTOR  
Ø 8mm



Code 856  
FEMALE  
CONNECTOR  
Ø 9,8mm



Code 812  
CONNECTOR  
FOR FUEL TANK  
FEMALE  
Ø 10,8mm



CONNECTOR  
FOR FUEL TANK MALE

Code	Type
815	Metal threaded



Code 816  
MALE  
CONNECTOR  
Ø 9,2mm



### BRASS FITTINGS

Code	Internal Tube Diam. mm
<b>3846-1</b>	6,35
<b>3846-2</b>	7,9
<b>3846-3</b>	10

### BRASS FITTINGS

Code	Thread mm	Internal Tube Diam. mm
<b>3847-1</b>		6,35
<b>3847-2</b>	1/4" NPT	7,9
<b>3847-3</b>		10



### BRASS FITTING

Code	NPT hose barb mm	Internal Tube Diam. mm
<b>3849</b>	1/4" NPT	6,35

### BRASS FITTING

#### «T» TYPE

It is combined with codes 3847\* and 3849.



Code	NPT hose barb mm
<b>3848</b>	1/4" NPT



### CHROMED BRASS VALVE CONNECTOR

Code	Internal tube Ø mm
<b>864</b>	10



### BRASS VALVES FOR TANKS

Code	Type	Diameter mm
<b>868 - 2</b>	3 WAY	6,35
<b>868 - 3</b>	4 WAY	6,35

MOTOR EQUIPMENT



### FUNNEL WITH FILTER

Code	Ø Upper part mm	Ø Lower part mm	Height mm
<b>875</b>	180	20	250



NEW

### PLASTIC FUNNEL

Code	Funnel diameter mm	Overall Length mm	Neck diameter mm	Neck Length mm
<b>603-1</b>	145	370	15	240



### FUNNEL WITH DOUBLE FILTER/ WATER-FUEL SEPARATOR

Made in USA.

Code	Height cm	Diameter cm	Flow Rate lt/min
<b>3632 - 21</b>	25,4	21,6	33,4

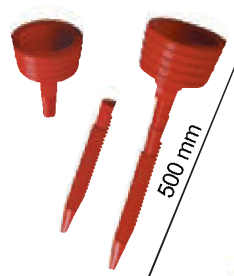

### Code 603 FUNNEL ANTIRROLING FOR ENGINE

It is a set of 2 pieces. The funnel and an extension with thread.



### FUNNEL WITH FILTER/WATER FUEL SEPARATOR

Made in USA.

Code	Height cm	Diameter cm	Flow Rate lt/min
<b>3620 - 09</b>	15,24	8,9	10,2
<b>3620 - 13</b>	22,86	14	14,7
<b>3620 - 20</b>	25,4	21,6	19



### Code 872 FLEXIBLE FUNNEL WITH FILTER

Ø 210 mm.



### BRASS OIL PUMP

Code	Dimensions mm
<b>1424</b>	L 200

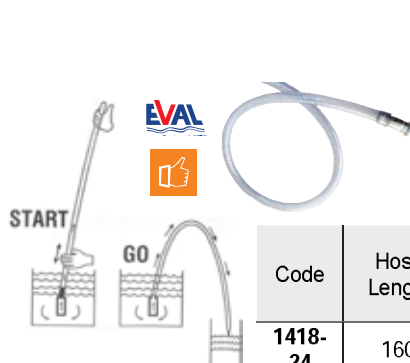

### PLASTIC HANDY PUMP WITH HOSE

Suitable for transferring fuel, water and various liquids.

Code	Hose Length	Diameter of metallic edge mm	Hose diameter mm	
			Internal Ø	External Ø
<b>1418-24</b>	160	30	20	25



### PLASTIC OIL CHANGE PUMP

The body is made of PE and the handle of ABS. The metal parts are made of regular carbon steel.

Code	Volume	Length
<b>2399</b>	0,8 lt	340 mm

**MANUAL OIL & FLUID EXTRACTOR PUMP 6,5Ltr**

The oil extractor can be used both on boat, in the car etc. The oil extracted is stored in the pump. Extraction tube kit, 1/4" extension tube, 5/16" extension tube are included.



Code	Capacity cm
3790	6,5 lt

**WATER FILTER**

Suitable for engine cooling system, to be fitted onto the motor's water intake. It is fully made of stainless steel 316 with easy inspection thanks to the tempered glass checking cover. It is made in accordance to R.I.N.A. standards.



NEW

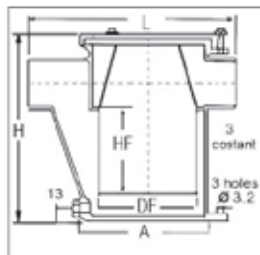

Code	Outlet mm		Dimensions mm				
			A	B	DF	HF	H
3343-1	3/4"	180	123	96	86	70	142
3343-2	1"	180	123	96	86	70	142
3343-3	1-1/4"	200	143	147	105	100	200
3343-4	1-1/2"	200	143	147	105	100	200
3343-5	2"	200	160	155	125	115	220

**WATER FILTER WITH TRANSPARENT PLASTIC COVER**

It is a 90° filter with 2 input/output for use in areas with lack of space. There is internal net.



Code	Diameter of input mm	Weight Kg
3612	25,4	3,2

3608

**COOLING WATER STRAINER**

Made of polypropylene with acrylic clear cap and polypropylene inner mesh.



3608-38

Diameter for Hose mm

3608	19
3608-38	38

**FUEL FILTER**

Code	For Tube Diam mm
4234	6 - 8

**FUEL FILTER**

Code	For Tube Diam mm
4233	9,5

**FUEL FILTER**

Code	For Tube Diam mm
3600	7

**IN-LINE STRAINER**

Made of plastic with stainless steel large mesh filter.

Code	Diameter for Hose mm
3606	19



**Code 3601-2  
SPARE METAL CONNECTOR**  
For code 3601. L 38mm x Ø 10mm

**FILTER AND WATER/GASOLINE SEPARATOR**

Transparent. Diminishes the danger of fire and improves the performance of the engine saving from 5-10% of the fuel. For hose 8mm diameter.

Code	Flow l/h
3603	50 - 400

Code of spare filter

3603 - 1

**Code 3601  
FILTER AND WATER/GASOLINE SEPARATOR**

Suitable mostly for engines more than 15HP. For hose 10mm diameter.

Code of spare filter

3601 - 1

**Code 3602  
FILTER AND WATER/  
GASOLINE SEPARATOR**

For engines up to 15HP. For hose 8mm diameter.



**FILTER AND WATER / GAZOLINE SEPARATOR WITH ALARM**

Code	Dimensions mm	Flow lt/h	
3605 - 1	180 x 90	50 - 150	
Code of spare filter	Code of spare cup	Code of spare indicator	Code of Spare sealing set
3605 - 2	3605 - 3	3605 - 4	3605 - 5



**FILTER AND WATER / GAZOLINE SEPARATOR**

Code	Dimensions mm	Flow lt/h	Code of spare filter	Code of spare cup
3605	180 x 90	50 - 150	3605 - 2	3605 - 3



**Code 1884  
SPARE FILTER FOR  
CODES 1836-1, 1866-  
1, 1836-2, 1866-2**



**Code 1836-2  
FILTER WATER-GASOLINE  
SEPARATOR WITH REUS-  
ABLE SEE-THROUGH  
BOWL KIT**  
Water separator of anodized aluminum. Reusable see-through bowl for 10 Micron filter. Connectors suitable for Mercury/Yamaha outboards.

Code of Spare Cup with Filter  
**1866 - 2**



**Code 1836-1  
FILTER WATER-GASOLINE SEPARATOR WITH  
REUSABLE SEE-THROUGH BOWL KIT**  
Water separator of anodized aluminum. Reusable see-through bowl for 10 Micron filter. Connectors suitable for Mercury/Yamaha outboards.

Code of Spare Cup with Filter  
**1866 - 1**





**Code 4361**  
**FILTER WATER – FUEL**  
**SEPARATOR MERCURY TYPE**  
For hose 10mm diameter.

Code of spare filter

**4361 - 1**



**Code 4362**  
**FILTER WATER – FUEL**  
**SEPARATOR OMC TYPE**  
For hose 10mm diameter.

Code of spare filter

**4362 - 1**

10 Micron



**Code 4486**  
**FILTER WATER –**  
**GASOLINE SEPARATOR FOR MERCURY**  
**WITH CLEAR BOWL**

Code	Flow lt/h
<b>4486</b>	227

Code of spare filter	Clear Bowl Only
<b>4486 - 2</b>	<b>4486 - 4</b>



**Code 4486 - 1**  
**FILTER WATER –**  
**GASOLINE SEPARATOR**  
**FOR MERCURY**  
**WITH ALUMINUM BOWL**

Code	Flow lt/h
<b>4486-1</b>	227

Code of spare filter
<b>4486 - 2</b>

10 Micron



**Code 4487**  
**FILTER WATER –**  
**GASOLINE SEPARATOR**  
**FOR YAMAHA**  
**WITH CLEAR BOWL**

Code	Flow lt/h
<b>4487</b>	340

Code of spare filter
<b>4487 - 2</b>

10 Micron



**Code 4487 - 1**  
**FILTER WATER – GASO-**  
**LINE**  
**SEPARATOR FOR**  
**YAMAHA**  
**WITH ALUMINUM BOWL**

Code	Flow lt/h
<b>4487-1</b>	340

Code of spare filter
<b>4487 - 2</b>

10 Micron



**FILTER**  
**WATER – GASOLINE**  
**SEPARATOR**  
Replaces RACOR S3227  
(RAC 320RRAC01)

Code	Flow lt/h
<b>4489</b>	227

Code of spare filter
<b>4489 - 1</b>



**Code 3604**  
**GASOLINE FILTER**  
With bracket. Suitable for all  
types of gasoline engines.  
Dimensions: Ç 176 mm, Ø 105 mm.  
With built in hose connector.  
For hose 8mm diameter.

Code of spare filter
<b>3604 - 1</b>



**SET OF FILTER**  
**CONNECTORS**  
suitable for all filter separators

Code	Thread	Intern. Tube Diam.
<b>4486-3</b>	3/8" NPT	10mm



NEW



#### Code 4426

##### WATER WARNING SYSTEM

Pre-assembled and ready-to-fit, it is specifically designed to work in synergy with fuel filters. Through a sophisticated, built-in electronic circuit and sensors, diagnosis of water contamination in fuel becomes very simple and accurate. G3 takes after the form of standard water/contaminant concentration bowls, commonly found equipped on marine fuel filters. Equipped with beeper that provides the user with an audio alarm. G3 provides fast and accurate water detection and warning for both diesel and gasoline engines.

The package contains :

- G3 main unit (Concentration bowl with built-in electronic circuit and sensors)
- Connecting cable 4.30 m (14 ft)
- Beeper
- Drain Plug
- Water drain valve
- Manual (incl. warranty coupon)

\*The box does not contain the filter and the filter housing.

Supply voltage	12 or 24 V
Active power consumption	20-30 mA
Operating temperature range	(-20) - (+75) °C
Diesel	yes
Gasoline	yes
Height	7,9 cm
Diameter	9,3 cm
System weight	375 g
Concentration bowl capacity	120 ml
Wiring length	4,3 m



NEW



#### Code 1690

##### PETROLEUM SYSTEM®™© (MPS)

The Metricon Petroleum System ®™© (MPS) is a fully digital, fuel flow and volume measuring device, with enhanced functions, (Patent Register number PCT GR 2009/000041) for special use in fuels, such as:

- Detection of air in the fuel flow
- Detection of water in fuel
- Measurement and reverse measurement (removes fuel volume)
- Measuring fuel temperature
- Calculating the volume that fuel has at 15oC
- Easy, quick and secure installation
- Fully portable, battery operated system
- Unobstructed flow of fuel (does not contain movable parts such as helices or other mechanical moving parts)
- Screen with 32 alphanumeric characters, 2 lines of text in Greek and English (other languages upon request)
- Ability to transfer data by the use of telematic technology

MPS®™© is patented worldwide.



NEW

#### Code 1686

##### FUEL SAVING DEVICE Fuel EX

FuelEx saves up to 30 % of fuels.

This technology allows much better engine combustion. Consequently gives more power, lower emissions and higher mileage / miles with the same quantity and quality of fuel. It is ideal for any type of fuel and provides fuel economy for cars, boats, engines, boilers, heavy machinery, generators, trucks, buses and coaches and any internal combustion engine.

The FuelEX ® creates a magnetic field supplied by two superparamagnets that is strong enough to release any fuel hydrocarbons dissolving molecules and thereby increase their energy, when combined with oxygen.

No fear of causing mechanical damage to the engine, since the placement of FuelEXX requires absolutely no intervention on the engine.

- Fuel saving up to 30%
- Automatic engine tuning
- Environment friendly
- Improves up to 20%
- Enhances engine performance
- Reduces carbon monoxide emission
- Cleans engine, carburetor and spark plugs
- Maintenance free
- Suitable for all boats and vehicles
- Easy to install



NYLON STEERING WHEEL WITH BLACK SPOKES

Code	Diameter mm
1657	320



NEW



STAINLESS STEEL STEERING WHEELS  
WITH SOFT RIM

Code	Color	Diameter mm
1677 - 32	black	320
1677 - 36	white	360

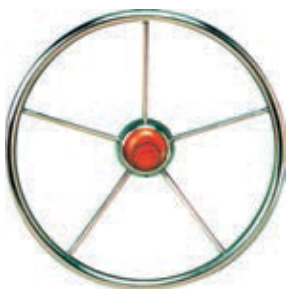

STAINLESS STEEL STEERING WHEEL

Code	Diameter mm
1654 - 32	320



NEW



STEERING WHEEL WITH THERMOPLASTIC MATERIAL

Code	Diameter mm
3502-BLACK	280



NEW



STEERING WHEELS IN  
THERMOPLASTIC MATERIAL  
with protection UV

Code	Diameter mm
3542 - BLACK	350
3542 - WHITE	
3542-GREY	



Code 3510  
STEERING HUB  
It is necessary for the  
codes 3542\*, 3503\* και  
3502



NEW



STEERING WHEEL WITH  
THERMOPLASTIC MATERIAL  
with protection UV

Code	Diameter mm
3503-BLACK	350
3503-WHITE	
3503-GREY	



#### FOAM STEERING WHEELS

Code	Diameter mm
1765	310



**ANODISED ALUMINUM FOAM STEERING WHEEL**  
EVAL wheel, of premium quality and competitive price.  
Color silver and black.

Code	Diameter mm
3912	320



**ANODISED ALUMINUM FOAM STEERING WHEEL**  
EVAL wheel, of premium quality and competitive price.  
Color silver and black.

Code	Diameter mm
3913	350



**ANODISED ALUMINUM FOAM STEERING WHEEL**  
EVAL wheel, of premium quality and competitive price.  
Color silver and black.

Code	Diameter mm
3905	310



**ANODISED ALUMINUM FOAM STEERING WHEEL**  
EVAL wheel, of premium quality and competitive price.  
Silver and black.

Code	Diameter mm
3943	350



**ANODISED ALUMINUM FOAM STEERING WHEEL**  
EVAL wheel, of premium quality and competitive price.  
Color silver and black.

Code	Diameter mm
3903	330



**Code 2957 WHEEL HUB KIT**  
Necessary part for the wheels with codes 3903, 3905, 3912, 3913, 3943



**STEERING WHEEL MADE OF ANODISED ALUMINUM, FOAM STEERING WHEEL**  
Silver painted

Code	Diameter mm
3900	355



**STEERING WHEEL FROM POLYURETHANE WITH STAINLESS STEEL SPOKES**

Code	Diameter mm
1572	320



**STEERING WHEELS MADE OF ACACIA WOOD WITH BRASS HUB**

Code	Diameter mm
1656 - 16	406
1656 - 20	508



**STANDING CONSOLE**

With front protection glass, Roll-Bar stainless steel and hatch.  
Made of fiberglass.

Code	Length x Width cm	Height cm
<b>132 - 1</b>	50 x 42	95 With roll bar 90 Without roll bar

**STANDING OVAL CONSOLE**

With front protection glass, Roll-Bar stainless steel and hatch.  
Made of fiberglass.

Code	Length x Width cm	Height cm
<b>132 - 2</b>	56 x 66	112 With roll bar 108 Without roll bar

MOTOR EQUIPMENT

**STANDING CONSOLE**

With front protection glass, Roll-Bar stainless steel and hatch. Made of fiberglass.

Code	Length x Width cm	Height cm
<b>132 - 7</b>	50 x 38	113 With roll bar 110 Without roll bar

**STANDING OVAL CONSOLE**

With front protection glass, Roll-Bar stainless steel and hatch.  
Made of fiberglass.

Code	Length x Width cm	Height cm
<b>132-10</b>	51 x 49	130 With roll bar 116 Without roll bar



#### STANDING OVAL CONSOLE

With hatch. Made of fiberglass. The steering wheel is not included.

Code	Dimensions cm with out roll bar
132-9	L35 x W 30 x H 65



#### STANDING OVAL CONSOLE

With hatch. Made of fiberglass. Available with front protection glass and inox roll bar.

Code	Length x Width cm	Height cm
132-12	L35 x W 30	86,5 With roll bar 83,5 Without roll bar



#### CONSOLE WITH SEAT

With storage space underneath the seat and additional storage space accessed by the hatch. It is equipped with front protection glass and stainless steel roll bar. Made of fiberglass

Code	Length x Width cm	Height cm
132-3	77X56	109 With roll bar 105 Without roll bar

Available spare pillow with code 3568-8



#### SQUARE CONSOLE WITH SEAT AND PILLOW

With storage space underneath the seat pillow and additional storage space accessed by the hatch. It is equipped with front protection glass and stainless steel roll bar. Made of fiberglass

Code	Length x Width cm	Height cm
132-6	84 x 66	110 With roll bar 103 Without roll bar

Available spare pillow with code 3568-6

\* NOTE: The steering wheel and the electric switch board are not included on the product



**OVAL CONSOLE WITH SEAT AND PILLOW**  
With storage space accessed by the hatch and inspection plug underneath the seat pillow. It has stainless steel roll bar. Made of fiberglass.

Code	Dimensions cm
132-11	L80 x W 52 x H 93

Available spare pillow with code 3568-7



**CONSOLE WITH JOCKEY SEAT**  
Made of fiberglass. With storage space under the seat.

Code	Dimensions cm
132 - 8	L 128 x W 47 x H 87



**CONSOLE WITH JOCKEY SEAT**  
Made of fiberglass. With storage space beneath the seat and a round hatch on the side.

Code	Dimensions cm
132 - 5	L 136 x W 41 x H 90

Available spare pillow with code 3568-9

\* NOTE: The steering wheel and the electric switch board are not included on the product

### POLYESTER SEAT WITH BACK & PILLOW

Comfortable and stylish with storage space. It has pillows, inox grip 60cm length, storage space underneath the seat pillow and at the back of the seat, where a big hatch is fitted. Resistant at the sea conditions thanks to its UV.

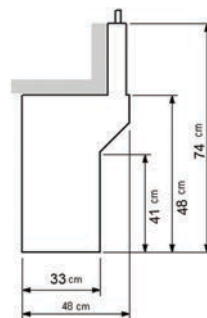

Code	Dimensions cm	Color
4874-4	L 86 x Depth 48 x H 82	White with grey pillows

\*Available spare pillow with code 3568-4



### PILLOWS FOR POLYESTER SEAT

Removable pillow consisted of two pieces, made of durable material. Suitable for seat with code 4874-5.

Code	Dimensions back pillow	Dimensions seat pillow	For code
3568-5	L62 x W 15,5	L64 x W 28	4874-5



### FOLDABLE SEAT-PILLOW for BOAT SEAT

Resistant and comfortable with reinforced hinges, made of polyurethane foam. It is combined with the boat seat code 4874-3.

Code	Dimensions cm	Color
3568-10	L80 x W 35 x H 48	Grey



MOTOR EQUIPMENT



### POLYESTER SEAT WITH BACK & PILLOW

Comfortable and stylish with storage space, suitable for limited space. It has pillows, plastic grip, storage space underneath the seat pillow and at the back of the seat, where a hatch is fitted. Resistant at the sea conditions thanks to its UV.

Code	Dimensions cm	Color
4874-5	L 65 x Depth 48 x H 65	White with grey pillows



### BOAT SEAT WITH STORAGE SPACE

Made of waterproof polyester with special storage space and and it can be combined with removable pillow with UV resistant code 3568\*.

Code	Dimensions cm	Color
4874 - 1	L58 x W 38,5 x H 35,5	White
4874 - 2	L100 x W 35 x H 35,5	
4874 - 3	L82 x W 35 x H 35,5	



### PILLOW FOR BOAT SEAT

Removable pillow with UV resistant for seat with code 4874\*.

Code	For code	Dimensions cm	Color
3568 - 1	4874 - 1	L58 x W 38,5 x H 6	White
3568 - 2	4874 - 2	L100 x W 35 x H 6	
3568 - 3	4874 - 3	L82 x W 35 x H 6	





# steerflex

## MEGA Rotary Steering Cable

### FEATURES

- Innovative patented core design features unique, two part system, core. Only the travel length of the core is coiled and the rest is nylon coated helical wire.
- Substantially reduced friction
  - Improved responsiveness
  - Increased durability
  - Significantly reduced corrosion

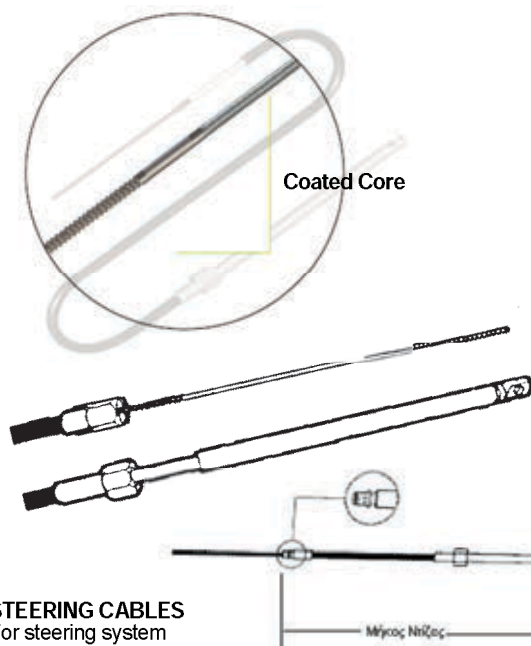

**STEERING CABLES**  
For steering system with code 1736.

Code	Feet	cm
1748 - 06	6	183
1748 - 07	7	213
1748 - 08	8	244
1748 - 09	9	274
1748 - 10	10	305
1748 - 11	11	335
1748 - 12	12	366
1748 - 13	13	396
1748 - 14	14	427
1748 - 15	15	457
1748 - 16	16	488
1748 - 17	17	518

Code	Feet	cm
1748 - 18	18	549
1748 - 20	20	610
1748 - 22	22	671

### STEERING SYSTEMS FEATURES

- Smoother operation and more durable than conventional rotary helm with single pinion gear.
- 3.8 turning revolutions from lock to lock.
- Standard 3/4" tapered shaft.
- Fast and easy installation with "EZ Clip" feature.
- Compact size.
- Maximum performance.
- Manufactured to meet or exceed A.B.Y.C., N.M.M.A., and IMCI (CE) certification requirements.
- Can generally be used on boats up to 25ft (7,6 m) in length.
- Maximum allowance steering wheel diameter is 16 inches (40,6cm).

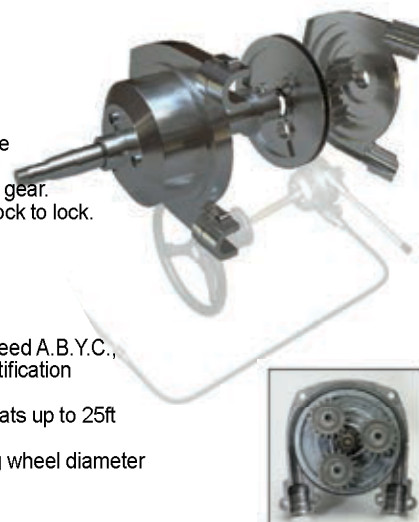

**Code 1736**  
**STEERING SYSTEM HEAVY DUTY**  
Suitable for boats up to 8 meters.  
Can be connected with steering cable code 1748.



**Code 4554**  
**STEERING SYSTEM ZTS**  
ZTS system minimizes torque from the engine. Suitable for boats up to 8 meters.  
Can be connected with steering cable code 1748.



**Code 1759**  
**MOUNTING BRACKET FOR STEERING SYSTEM 90°**  
For steering system with code 1736, 3931-1, 4554, 4555.



**Code 1752**  
**MOUNTING BRACKET FOR STEERING SYSTEM 20°**  
For steering system with code 1736, 3931-1, 4554, 4555.



**Code 1773**  
**STEERING CABLE ADAPTOR**  
With thread diameter 24mm. It connects the steering cables code 1748\* with bigger engines.

**Code 4555**  
**TWIN STEERING SYSTEM**  
Suitable for boats up to 8 meters. Can be connected with steering cable code 1748.

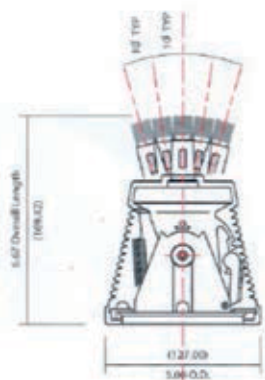

#### TILT MECHANISM

For the adjustment of the wheel position. 5 tilt positions within 40 degree range. Cable travel 228 mm. 3 turns lock to lock. Maximum wheel size: 406 mm diameter. Connects with steering systems with code 3931-1 and 3931-2.



Code 1685  
NUT - RONDELLE - VO-  
LAN



TILT MECHANISM  
BOOT  
(FOR CODE 3929)



#### Code 3931-1 STEERING SYSTEM

Suitable for boats up to 8 meters. Can be connected with steering cable code 1748. Cable travel 228 mm. 3,8 turns lock to lock. Maximum wheel size: 406 mm diameter. Connects with the Tilt mechanism with code 3929.



#### Code 1723 STEERING SYSTEM

Suitable for boats up to 5 meters. Can be connected with steering cable code 1730. Lock to lock steering wheel turns: approx. 2,5. Stroke: 230mm. Maximum allowable steering wheel diameter: 380 mm.

Code	Dimensions mm
3929	H 169 x L 127 x W 127

Code
3930 - BLACK
3930 - WHITE

steerflex

#### STEERING CABLES

For steering system with code 1723.

Code	Feet	Cm
1730 - 07	7	213
1730 - 08	8	244
1730 - 09	9	274
1730 - 10	10	305
1730 - 11	11	335
1730 - 12	12	366
1730 - 13	13	396
1730 - 14	14	427
1730 - 15	15	457
1730 - 16	16	488
1730 - 17	17	518

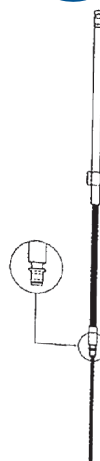

Teleflex  
MARINE



Code 1737  
HEAVY DUTY STEERING SYSTEM  
Suitable for outboard engines up to 200 hp. Can be connected with steering cable code 1740 Lock to lock steering wheel turns: approx. 3. Stroke: 228 mm. Maximum allowable steering wheel diameter: 406 mm.



Code 1738  
MOUNTING  
BRACKET FOR  
STEERING SYS-  
TEM 90°

For steering system with code 1737.



Code 1739  
MOUNTING  
BRACKET FOR STEERING  
SYSTEM 20°

For steering system with code 1737.

NEW



Code 1737-1  
HEAVY DUTY STEERING SYSTEM  
Heavy duty steering system, easy to connect Suitable for boats up to 9 meters and up to 200HP for single engine application. Can be connected with steering cable code 1740 Lock to lock steering wheel turns: approx. 4. Maximum allowable steering wheel diameter : 400 mm. Standard 3/4" tapered shaft of galvanized steel



NEW

Code 1739-1  
MOUNTING BRACK-  
ET FOR STEERING  
SYSTEM 20°  
For steering system with code 1737-1.



NEW

Code 1738-1  
MOUNTING BRACK-  
ET FOR STEERING  
SYSTEM 90°  
For steering system with code 1737-1.



steerflex

#### STEERING CABLES

For heavy duty steering system with code, 1737. They are also compatible with UFLX steering systems.

Code	Feet	cm
1740 - 08	8	244
1740 - 09	9	274
1740 - 10	10	305
1740 - 11	11	335
1740 - 12	12	366
1740 - 13	13	396
1740 - 14	14	427
1740 - 15	15	457
1740 - 16	16	488
1740 - 18	18	549
1740 - 20	20	579



Code 3457  
CONVERSION FOR HEAVY  
DUTY STEERING CABLES  
For code 1737. It connects the thread of the steering system code 1737 with the cables code 1740\*



Code 1751  
KIT FOR STEERING CA-  
BLE CONNECTION WITH  
OUTBOARD MOTOR



**Code 1750**  
**KIT FOR STEERING CABLE CONNEC-**  
**TION WITH BALL JOINT FOR**  
**OUTBOARD MOTOR**  
It is combined with code 3175.



**Code 3175**  
**STAINLESS STEEL**  
**TRACK ROD**  
For two engines.  
Opening max: 62 cm



**Code 1153**  
**TILLER ARM**  
For engines OMC, JOHNSON, EVINRUDE.



**Code 3916**  
**STEERING CABLE**  
**SUPPORTING**  
**SHORT BRACKET**  
Available spare tube with code 1749-1.



**Code 1152**  
**SPLASHWELL MOUNTING FOR**  
**STEERING CABLE**  
Also available spare tube code 1749-1.



**Code 1749**  
**STEERING CABLE SUPPORTING**  
**BRACKET ON THE MIRROR FOR**  
**THE CONNECTION WITH**  
**THE ENGINE**  
Also available spare tube code 1749-1.



**Code 1749 - 1**  
**SUPPORT TUBE**  
Length 290 mm.

**STAINLESS STEEL PEDESTAL**  
Pedestal steering system with lateral plate and  
aluminum foot. Helm, steering wheel and cables  
are not included.

Code	Dimensions cm
<b>4932</b>	H 85 x L 29 x W 39



### HYDRAULIC STEERING SYSTEMS OF THE COMPANY MAVIMARE & MANCINI

The hydraulic steering systems of the Italian company MAVIMARE & MANCINI are an effective combination of excellent craftsmanship and innovative technology ensuring optimum performance under all conditions. The quality of materials is undoubtedly superior, all pieces are made of corrosion-resistant material to ensure long life and reliability.



#### Code 1732 - 1

#### HYDRAULIC STEERING SYSTEM FOR OUTBOARD ENGINES UP TO 300 HP

Kit composed of: hydraulic pump, cylinder, 2 bottles of hydraulic oil and 2 pipes, 7 m each that can be cut to the desired size. Available Oring seal kit for the cylinder. Suitable for engines 300HP with reverse turning propellers.

Code	Cylinder			Pump			
	Capacity cm <sup>3</sup>	Stroke mm	Ø mm	Number of pistons	Max Pressure bar	Capacity cm <sup>3</sup>	Weight Kg
1732-1	130	198	18	7	70	27	3,7



#### Code 1732 - 2

#### HYDRAULIC STEERING SYSTEM INBOARD ENGINES FOR BOATS 5,5m UP TO 9,5m

Kit composed of hydraulic pump, cylinder, 2 lt of hydraulic oil, and 2 pipes of 7,5 meters each that can be cut to the desired size.

Code	Cylinder					Pump			
	Capacity cm <sup>3</sup>	Stroke mm	Max pressure bar	Ø mm	Weight Kg	Number of pistons	Max Pressure bar	Capacity cm <sup>3</sup>	Weight Kg
1732-2	83	150	80	30	3	7	70	27	3,7



#### Code 1732 - 3

#### HYDRAULIC STEERING SYSTEM FOR STERDRIVE ENGINES UP TO 300 HP

Kit composed of: hydraulic pump, cylinder, 2lt of hydraulic oil and 2 pipes 15m each that can be cut to the desired size.

Code	Cylinder			Pump			
	Capacity cm <sup>3</sup>	Stroke mm	Ø mm	Number of pistons	Max Pressure bar	Capacity cm <sup>3</sup>	Weight Kg
1732-3	146	200	15	7	70	32	3,7



#### Code 1732-4

#### HYDRAULIC STEERING SYSTEM FOR OUTBOARD ENGINES UP TO 150HP

Kit composed of: hydraulic pump, cylinder, 2 lt of hydraulic oil and 2 pipes 6 m each that can be cut to the desired size.

Code	Cylinder			Pump			
	Capacity cm <sup>3</sup>	Stroke mm	Ø mm	Number of pistons	Max Pressure bar	Capacity cm <sup>3</sup>	Weight Kg
1732-4	83	200	16	7	70	17	2,8





NEW

**HYDRAULIC STEERING SYSTEM FOR OUTBOARD ENGINES UP TO 80HP**

The hydraulic steering system is consisted of hydraulic pump, frontal mounting cylinder bull horn type, 1lt of hydraulic oil and 2 pipes of 5 meters each one. The steering system is suitable for all outboard engines. For connecting with YAMAHA 40/50/60 it is required the KIT with code 1732-12.

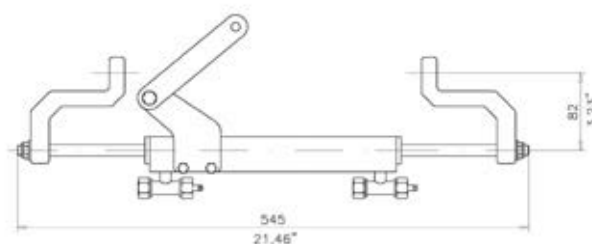
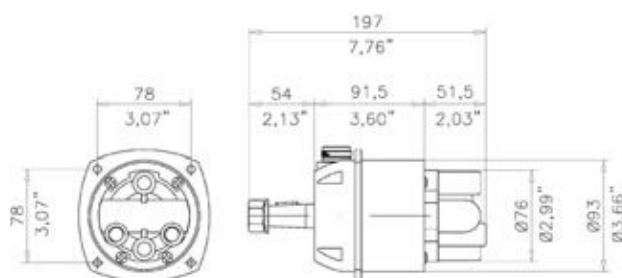

Code	Cylinder			Pump		
	Capacity cm <sup>3</sup>	Stroke mm	Ø mm	Number of pistons	Max pressure bar	Capacity. cm <sup>3</sup>
<b>1732-6</b>	75	545	12	7	50	14

**INBOARD HYDRAULIC STEERING SYSTEM FOR BOATS FROM 6m UP TO 12,5m**

Kit composed of hydraulic pump, cylinder, 2 lt of hydraulic oil, and 2 pipes of 7,5 meters each that can be cut to the desired size.

Code	Cylinder					Pump			
	Capacity cm <sup>3</sup>	Stroke mm	Max pres- sure bar	Ø mm	Weight Kg	Number of pistons	Max Pressure bar	Capacity cm <sup>3</sup>	Weight Kg
<b>1731</b>	130	215	80	32	3,5	7	70	27	3,7



NEW

**INBOARD HYDRAULIC STEERING SYSTEM FOR BOATS FROM 24 TO 44 FT (8-13 METERS)**

Kit composed of hydraulic pump, cylinder, 2 lt of hydraulic oil, and 2 pipes of 7,5 meters each. The cylinder head and chrome plated brass body and cylinder's shaft 316 inox steel.

Code	Cylinder					Pump			
	Capacity cm <sup>3</sup>	Stroke mm	Max pres- sure bar	Ø mm	Weight Kg	Number of pistons	Max Pressure bar	Capacity cm <sup>3</sup>	Weight Kg
<b>1732-5</b>	164	215	100	35	4	7	60	32	5,5



**Code 1735**  
**HOSES AND FITTINGS KIT FOR DOUBLE CYLINDER CONNECTION**  
Kit composed of 2 pieces of hose 7,5meters, fittings, and 2 lt of oil that can be cut to the desired size

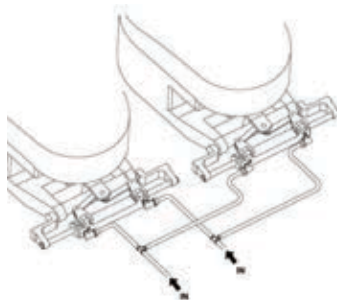

**Code 1741**  
**HOSES AND FITTINGS FOR AUTOPILOT CONNECTION**  
Kit composed of 2 pieces of 60 cm hoses, 1 piece of 6 meter hose for helm pump-autopilot connection and fittings that can be cut to the desired size.

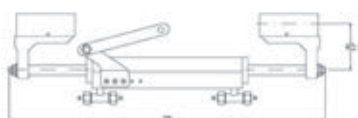

NEW

**HYDRAULIC STEERING SYSTEM'S BALANCED CYLINDER OF FRONTAL MOUNTING**  
For code 1732-4

Code	Capacity cm <sup>3</sup>	Length mm	Ø Shaft mm	For code
<b>1732-11</b>	83	200	16	1732-4

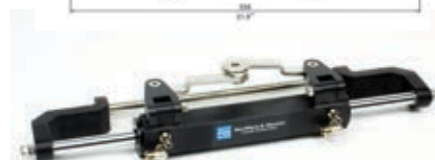
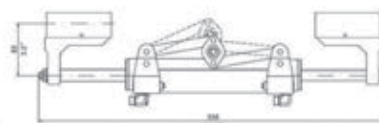

NEW

**HYDRAULIC STEERING SYSTEM'S BALANCED CYLINDER OF FRONTAL MOUNTING**  
For code 1732-1

Code	Capacity cm <sup>3</sup>	Length mm	Ø Shaft mm	For code
<b>1732-13</b>	130	198	18	1732-1

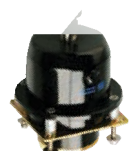

NEW

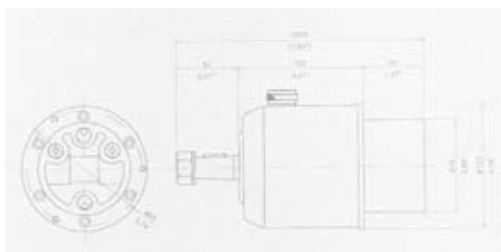

**PUMP FOR HYDRAULIC STEERING SYSTEM 150HP**

Code	Number of pistons	Max Pressure bar	Capacity cm <sup>3</sup>	Weight Kg	For code
<b>1732-16</b>	7	70	17	2,8	1732-4



NEW

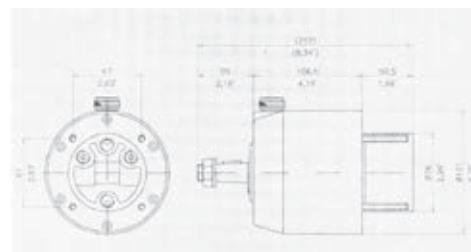

**PUMP FOR HYDRAULIC STEERING SYSTEM 300HP**

Code	Number of pistons	Max Pressure bar	Capacity cm <sup>3</sup>	Weight Kg	For codes
<b>1732-18</b>	7	70	27	3,7	1732-1 1732-2 1731



**HOSES KIT 1/4 FOR HYDRAULIC STEERING SYSTEM**  
Suitable for code 1732-4.

Code	Length m	For code
<b>1732-19</b>	4,27 m	1732-4
<b>1732-20</b>	4,88 m	
<b>1732-21</b>	5,49 m	

NEW



**HOSES KIT 5/16 FOR HYDRAULIC STEERING SYSTEM**  
Suitable for codes 1732-1, 1732-2, 1732-3, 1731.

Code	Length m	For codes
<b>1732-22</b>	4,88 m	1732-1
<b>1732-23</b>	5,49 m	1732-2
<b>1732-24</b>	6,10 m	1732-3
<b>1732-25</b>	6,71 m	1731

NEW



NEW

**Code 1732-14**
**KIT FOR HONDA 115/130 ENGINE**

It is necessary for application on Honda 115/130HP engines.  
For code 1732-1.



NEW

**Code 1732-12**
**KIT FOR YAMAHA 40/50/60 ENGINE AND HONDA 115/130 ENGINE**

It is necessary for application on Yamaha 40/50/60HP and Honda 115/130HP engines.  
For code 1732-4.

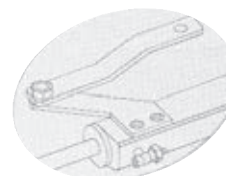
**Code 1732-15**
**KIT FOR MERCURY OPTIMAX 115HP ENGINE**

It is necessary for application on MERCURY OPTIMAX 115HP engines. For code 1732-1.



NEW

**Code 1718**
**TIE BAR KIT FOR CYLINDER-CENTRE ENGINE**

The tie bar kit is suitable for connecting 2 engines with one cylinder.

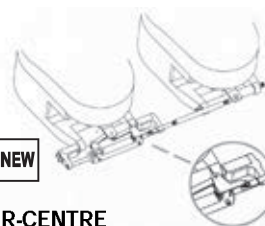

NEW

**Code 1791**

**FULL VENT PLUG**  
For hydraulic steering systems.



NEW

**OIL FOR HYDRAULIC STEERING SYSTEM**

Suitable for all steering systems.

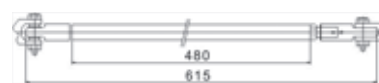
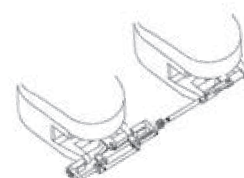
**Code 1742**
**TIE BAR FOR TWIN OUTBOARD ENGINES**

NEW

**DUAL THRU-HULL HOSE KIT**

Kit for passing hydraulic tubes.

Code	Dimensions mm
1780	106 x 89

Code	Content
1799	1 lt



NEW

**BULKHEAD KIT FOR DUAL HOSE**

Bulkhead kit for dual hose with preassembled fittings.

Code	Dimensions mm
1785	106 x 89



NEW

**Code 1760**
**CONNECTION FILLER TUBE KIT**

NEW

**Code 1716**
**TIE BAR FOR TWIN ENGINE UP TO 300HP**

Stainless Steel 316.  
Length 640 mm – 780 mm

**Code 4504**
**WIRE STEERING GROMMET (2 SOCKETS) Ø 75 / 105 mm**

**BULKHEAD STRAIN RELIEF HOSE KIT FOR HYDRAULIC SYSTEMS**

Code	Diameter Flange mm
3621	70

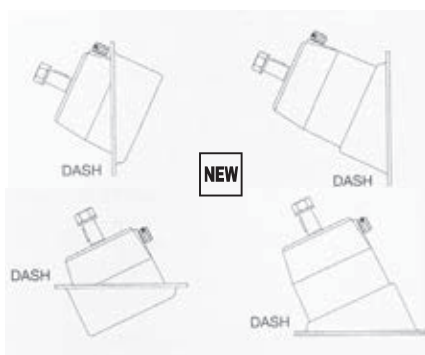

NEW

**KIT TO MOUNT THE HELM**

Kit designed to mount the helm at 25° angle to the mounting surface.

Code	Type	Dimensions mm
1778-1	Suitable for pumps of hydraulic steering systems 150HP	127 x 141,5
1778-2	Suitable for pumps of hydraulic steering systems 300HP	146 x 172



NEW

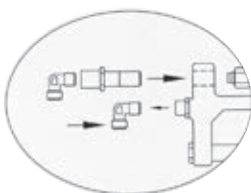

**Code 1747**

**KIT FOR CONNECTION TRANSFORMATION**

The kit is used to have frontal hoses connections when clearance between the end of steering cylinder to the motorwell wall is not enough to connect the hoses laterally.



NEW

**HOSES ADAPTOR FITTINGS FOR T FITTINGS OF VERADO ENGINE**

Code	Thread	For VERADO	Type
<b>878-1</b>	M16X1,5	To 9/16-18UNF	Set of 2 pieces
<b>878-2</b>	9/16-24UNF	To 9/16-18UNF	Set of 2 pieces



NEW

**STEERING FITTING – CONNECTOR “T” TYPE**

Code	Thread inch	Diameter mm
<b>866-1</b>	1/4"	10
<b>866-2</b>	3/8"	10



NEW

**STEERING FITTING – CONNECTOR “T” TYPE WITH BLEEDER**

Code	Thread inch	Diameter mm
<b>869</b>	1/4"	10



NEW

**TUBE CONNECTOR MALE**

Code	Thread inch	Diameter mm
<b>876-1</b>	1/8"	8
<b>876-2</b>	1/4"	8
<b>876-3</b>	1/4"	10
<b>876-4</b>	3/8"	10



**BRASS FITTINGS FOR HYDRAULIC STEERING SYSTEM**

Code	Ø of hose mm
<b>871-1</b>	6,35
<b>871-2</b>	7,9



**BRASS FITTING FOR HYDRAULIC STEERING SYSTEM**

Code	Thread mm	For hose diameter mm
<b>870</b>	6,35	10



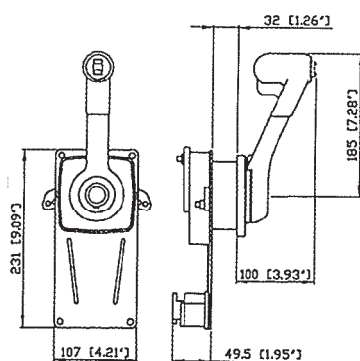

### Code 1672

#### LEVER CONTROL

Single lever control, left or right side mount installation. Suitable for all types of engine. With 'N' (neutral) lock.

Pull-out handle disengages shift for warm -up. With power trim switch. Made of anodized aluminium and reinforced plastic. Suitable for types of engine control cables C2, C8, C14 and C5 with KIT 1720.

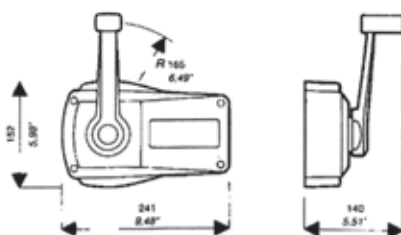

### Code 1671

#### LEVER CONTROL

Single lever control, left or right side mount installation. Suitable for all types of engine. With 'N' (neutral) lock. Pull-out handle disengages shift for warm -up. Made of anodized aluminium and reinforced plastic. Suitable for types of engine control cables C2, C8, C14 and C5 with kit 1720.

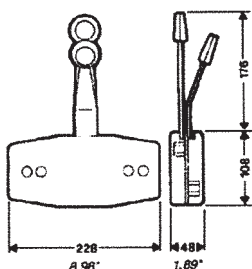

### Code 1670

#### LEVER CONTROL

Double lever suitable for small outboard engines, left or right side mount installation. Made of nylon fiberglass with anodized aluminum levers. Suitable for types of engine control cables C2, C8, with KIT 1722

C14 with KIT 1721

C5 without connection KIT.

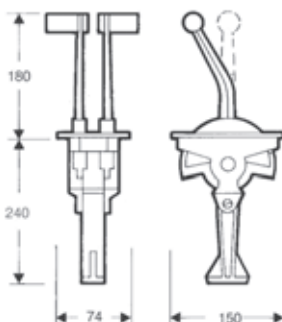

NEW

### Code 1879

#### TWO LEVER / SINGLE ACTION LEVER CONTROL

Lever control made of anodized aluminum and chrome. Suitable for all engines. Two lever / single action control: each lever operates separately either the throttle or shift. It features interlock system to prevent accidental gear engagement. Suitable for mounting on flying bridge. Connected with cables controller C2, C8, C0 and C22 using K22 kit.



Code 1720  
KIT TO CONNECT C5  
CABLES TO SINGLE  
LEVER CONTROL BOXES



Code 1721  
KIT TO CONNECT C14  
CABLE TO LEVER  
CONTROL BOX 1670



Code 1722  
KIT TO CONNECT C2, C8  
CABLES TO LEVER  
CONTROL BOX 1670

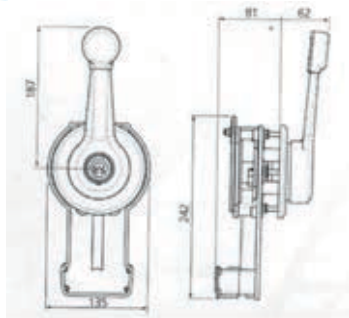

Code 1673

#### LEVER CONTROL RIVIERA

Engine control box controls both the inverter and accelerator. Made of innovative material ISEF plastic, resistant both to wear and atmospheric agents. All accessory parts are made of stainless steel. With 'N' (neutral) lock. Pull-out handle disengages shift for warm-up. Suitable for types of engine control cables C2, C8, C14 and C5.



Code 1680

#### LEVER CONTROL RIVIERA

Engine control box controls both the inverter and accelerator. Made of innovative material ISEF plastic, resistant both to wear and atmospheric agents. All accessory parts are made of stainless steel. With 'N' (neutral) lock. Pull-out handle disengages shift for warm-up. Suitable for types of engine control cables C2, C8, C14 and C5.

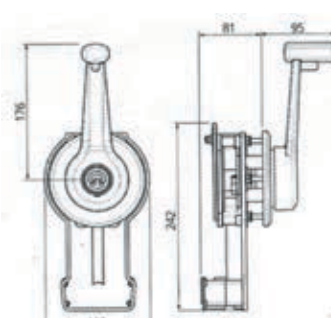

#### Code 1763 SELECTOR UNIT FOR DUAL STATION APPLICATION

The selector unit is fitted in dual station installations with single lever control boxes and recommended for maximum efficiency with two lever control boxes. The selector unit assures a smoother operation and permits the independent action of throttle and gear shift controls from either flying bridge and main helm station.

Note : when changing station, throttle must be at minimum and gearshift in neuter position. As an alternative to selector unit installation, in case cable length is not excessive and single lever not used, it is possible to mount in series. Made entirely of corrosion resistant materials and easily mounted.



Code 1680-1  
**LEVER CONTROL RIVIERA WITH TRIM**  
The same as the lever control with code 1680 equipped with TRIM and fast connector.

#### Code 1605 SIDE LEVER CONTROL

Lever control box suitable for all outboard engines. It is connected with engine control cables YAMAHA, SUZUKI, NISSAN, TOHATSU.

Equipped with :

- Ignitions switch
- Hand throttle
- Quick stop
- Engine trim
- 10pin YAMAHA

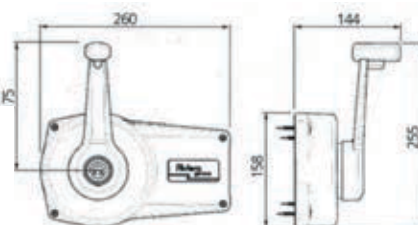

Code 1681

#### LEVER CONTROL RIVIERA

Engine control box controls both the inverter and accelerator. Made of innovative material ISEF plastic, resistant both to wear and atmospheric agents. All accessory parts are made of stainless steel. With 'N' (neutral) lock. Pull-out handle disengages shift for warm-up. Suitable for types of engine control cables C2, C8, C14 and C5.



Code 1681-1  
**LEVER CONTROL RIVIERA WITH TRIM**  
The same as the lever control with code 1681 equipped with TRIM and fast connector.



#### ELECTRONIC LEVER CONTROL RIVIERA

Single or double lever control for one or two engines. Operates both shift and throttle with one handle..

Code	Description
4217 - 1	SINGLE LEVER CONTROL/FOR ONE ENGINE
4217 - 2	DOUBLE LEVER CONTROL/FOR TWO ENGINES

Code 4218

**CONTROL UNIT BOX**  
For the electronic lever control with code 4217-1 & 4217-2





**Code 1674**

**LEVER CONTROL PRETECH**

Single lever Throttle control for one engine. Suitable for all types of engine. It can be connected with engine control cables C8, C2. Contains connection kit.



**Code 1675**

**LEVER CONTROL**

Double lever control for one engine, Throttle & Clutch. Suitable for all types of engine. It can be connected with engine control cables C8, C2. Contains connection kit.



**Code 3919  
LEVER CONTROL  
PRETECH**

Double lever control for two engines. Twin lever Throttle & Throttle. Suitable for all types of engine. It can be connected with engine control cables C8, C2. Contains connection kit.



**Code 3918  
LEVER CONTROL  
PRETECH**

Double lever control for two engines. Twin lever Clutch & Clutch. Suitable for all types of engine. It can be connected with engine control cables C8, C2. Contains connection kit.



3917 - 1

3917 - 2

**LEVER CONTROL PRETECH**

Single or double lever control for one or two engines. Operates both Clutch and Throttle with one handle. Can be mounted left or right handed. Suitable for all types of engine. With "N" (neutral) lock. It can be connected with engine control cables C8, C2. Contains connection kit.

Code	Description
3917 - 1	SINGLE LEVER CONTROL / FOR ONE ENGINE
3917 - 2	DOUBLE LEVER CONTROL / FOR TWO ENGINES

MOTOR EQUIPMENT



**Code 3920**

**SINGLE CONTROL LEVER**

Throttle control. Made of chromed brass.



**Code 3920-2**

**DOUBLE CONTROL LEVER**

Throttle and Clutch control. Made of chromed brass.



**Code 1674-1**

**LEVER CONTROL**

Single control top mount BCP for inboard engine. Operates clutch only.

**TMC**



2901



2902 2903

2905

2904

**SECURITY STOP KEY WITH SPIRAL STRING/ QUICK STOP**

Code	Motor
2901	MARINER MERCURY
2902	MARINER SUZUKI
2903	TOHATSU
2904	HONDA-OMC
2905	YAMAHA-SAIL - PARSUN
2906	PARSUN



**NEW**

**Code 2925**

**QUICK STOP**

Includes 10 KEYS that fit all Johnson, Evinrude, Mercury, Yamaha and Honda kill switches. Swivel snap hook prevents tangles in blister packs.



**NEW**

**QUICK STOP**

Emergency Cut Off Switch with Lanyard and Clip Suitable for fitting on the console or anywhere else.

Code	Volt	Amps
2900	12 V	10A

# maxflex CONTROL CABLES

## REVOLUTIONARY NEW TECHNOLOGY RESULTS IN MAXIMUM EFFICIENCY AND REDUCED BACKLASH

Maximized cable efficiency by reducing 50% of the contact area of core-to-liner when minimal input force is applied. Results in lower backlash at all input force by reducing clearance and contact area between core and liner.

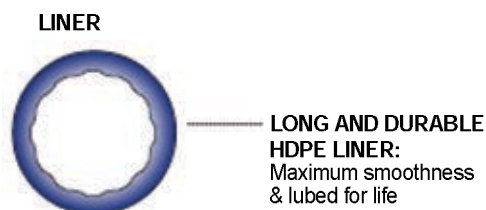
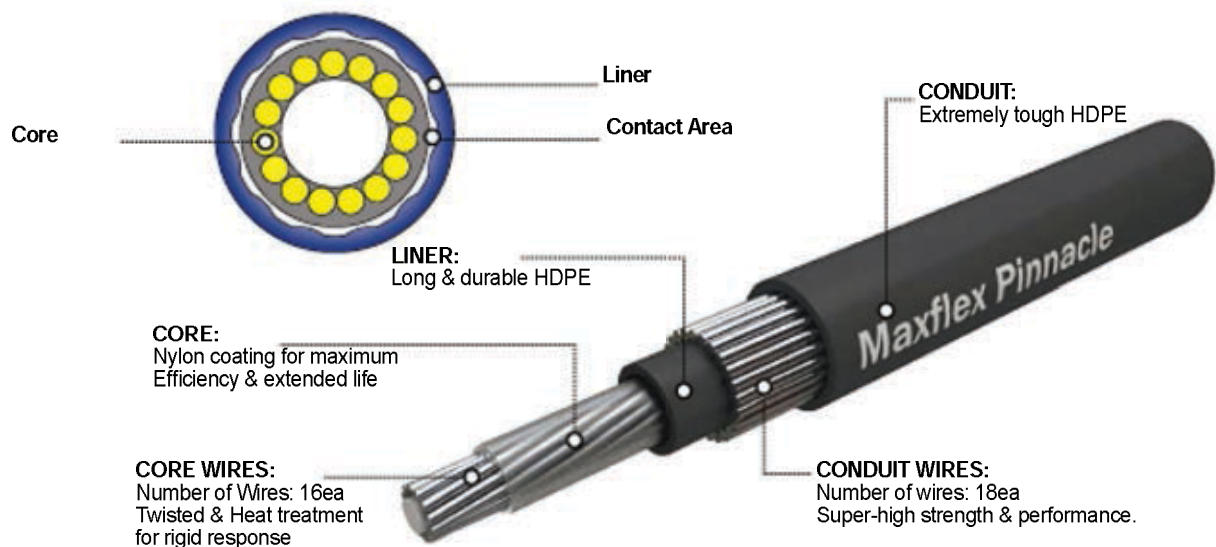

## FEATURES

- MAXFLEX Control Cable employs the revolutionary design of grooved liner with minimum contact area to core.
- Twisted steel lay wire construction: extremely resistant to high temperature compared to straight lay wire.
- Durable UV resistant HDPE outer casting resistant to salt water, chemicals petrol & oil, and other environmental elements.
- Exceed all marine & industry standards.
- Lifetime lubricated and sealed.





## ENGINE CONTROL CABLES

1696 - 08	8	244
1696 - 09	9	274
1696 - 10	10	305
1696 - 11	11	335
1696 - 12	12	366
1696 - 13	13	396
1696 - 14	14	427
1696 - 15	15	457
1696 - 16	16	488
1696 - 18	18	549
1696 - 20	20	610

C5  
FROM 8 UP TO 20 FEET  
For outboard engines: MERCURY,  
MARINER, MERCUISER



1709 - 05	5	152
1709 - 06	6	183
1709 - 08	8	244
1709 - 09	9	274
1709 - 10	10	305
1709 - 11	11	335
1709 - 12	12	366
1709 - 13	13	396
1709 - 14	14	427
1709 - 16	16	488
1709 - 18	18	549
1709 - 20	20	610
1709 - 22	22	671
1709 - 24	24	732

C8  
FROM 8 UP TO 24 FEET  
For all inboard engines.  
For outboard engines: YAMAHA,  
SUZUKI, TOHATSU, HONDA.  
For sterndrive engines VOLVO.



1683 - 08	8	244
1683 - 09	9	274
1683 - 10	10	305
1683 - 11	11	335
1683 - 12	12	366
1683 - 13	13	396
1683 - 14	14	427
1683 - 15	15	457
1683 - 16	16	488
1683 - 18	18	549

C14  
FROM 8 UP TO 20 FEET  
For inboard and outboard engines  
(manufactured after 1979):  
OMC, JOHNSON, EVINRUDE.





Code 3914-1  
OMC STERNDRIIVE  
CABLE ADAPTER



Code 3914-2  
JOHNSON/EVINRUDE  
OUTBOARD CABLE  
ADAPTER



Code 3914-3  
MERCURY  
OUTBOARD  
CABLE ADAPTER



Code 3914-4  
MERCURUISER  
STERNDRIIVE  
CABLE ADAPTER



Code 3915-1  
MERCURY  
CONTROL  
ADAPTER  
FOR C5 CABLES



Code 3915-2  
OMC  
CONTROL  
ADAPTER  
FOR C14 CABLES



Code 3926  
STAINLESS  
CABLE HOOK  
CLIP FOR C8  
CONTROL CABLES



Code 3927  
BRASS PIVOT  
FOR C8 CABLES



Code 3928  
BRASS STOP COLLAR  
FOR C8 CABLES



Code 3925  
TERMINAL EYE  
PIVOT FOR  
C8 CABLES



Code 3922  
CLEVIS JOINT  
FOR C8 CABLES



Code 1710  
BALL JOINT FOR  
ENGINE CONTROL  
CABLES  
For codes 1709,1676.



Code 3924  
STAINLESS  
STEEL SHIM



Code 3923  
STAINLESS  
STEEL CLAMP  
FOR C8 CABLES



Code 1743  
KIT FOR CONTROL  
CABLES  
Suitable for control cables C2 and  
C8 with codes 1676\*and 1709\*



**Code 3879**  
**PIPE FOR OUTBOARD**  
**CABLE PASSAGE**  
 Flexible, made of reinforced PVC.  
 For code 3881, Grey.  
 Internal diameter 50 mm  
 External Diameter 62 mm  
 Available in rolls of 15m.



**PLASTIC FLANGE**  
 To join code 3879.  
 Ø 56 mm.



Code	Diameter mm
3881-WHITE	56
3881-BLACK	



**PROTECTIVE CABLE**  
**SYSTEM WITH CAP**

Code	Length cm	Diameter mm
1385-100	100	56

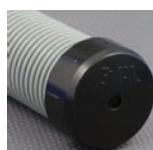

**Code 1385**  
**PLUG FOR CABLES'**  
**PROTECTION HOSE**  
 For codes 1385-100 & 3879



**BULKHEAD STRAIN RELIEF HOSE KIT**  
 Manufactured in P.V.C. material. It allows an easy replacement of a broken one without detaching cables from the engines. You have to apply the clamps in the dedicated grooves, holding tightly the grommet on the rigid inner core, keeping its natural shape. Supplied with storage packaging.

Code	Dimensions mm
4673	Ø 115 x H135



**Code 4504**  
**WIRE STEERING GROMMET(2 SOCKETS) Ø 75 / 105 mm**



**ADJUSTABLE STEERING**  
**GROMMET EVAL**  
 With plastic clamp, for steering cables and wires in two colors, grey and black.

Code	Height mm	Diameter mm
967 - BLACK		
967 - WHITE	110	65



**STEERING GROMMET EVAL**  
 For steering cables and wires in two colors, white and black.

Code	Height mm	Diameter mm	
		Inside	Outside
3003 - BLACK	70	60	105
3003 - WHITE			

Code	Height mm	Diameter mm
3004 - BLACK	68	105
3004 - WHITE		



**Code 969**  
**PLASTIC RING**  
 Ø 75 / 105 mm.



**FAIRLEAD RING**

Code	Diameter mm
965 - BLACK	58 / 89
965 - WHITE	



**FAIRLEAD RING PLASTIC**

Code	Diameter mm
963 - BLACK	86
963 - WHITE	

### ROLLING BRACKET FOR AUXILIARY OUTBOARD ENGINES

The pipes and all the base metal parts are made of INOX 316. It is equipped with auto safety locks for all positions and fastening belt of the outboard engine for maximum safety. It is equipped with rollers made of Teflon. Suitable for all types of engines up to 15HP and 60Kgr. It facilitates the launching of the outboard engine.

NEW

Code	Dimensions cm	Wooden base cm
2311	L 60,5 x W 28,5 x H 20 cm	13 x 20

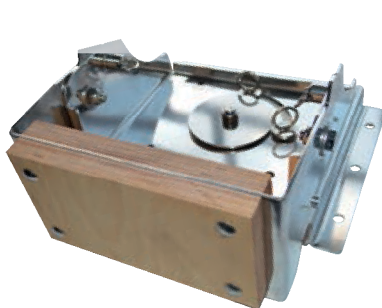
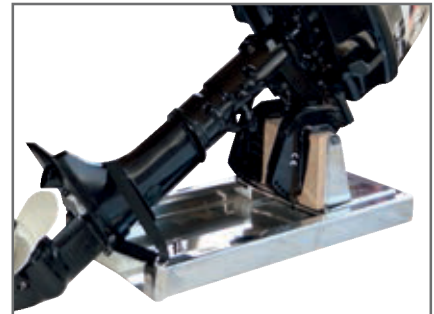
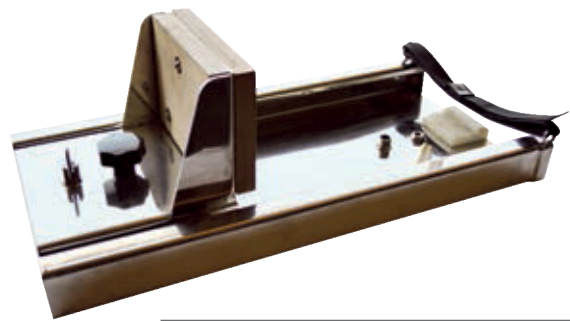

### ROTATING BRACKET FOR AUXILIARY OUTBOARD ENGINES

INOX 316. Rotating bracket 90° on the boat platform with recovery and auto safety locks. Suitable for all types of engines up to 15HP and 60Kg. Ideal for boat platform. Very durable heavy type construction stainless steel 316.



Code	Dimensions cm
2309	L 31 cm x W 24 cm x H 14 cm

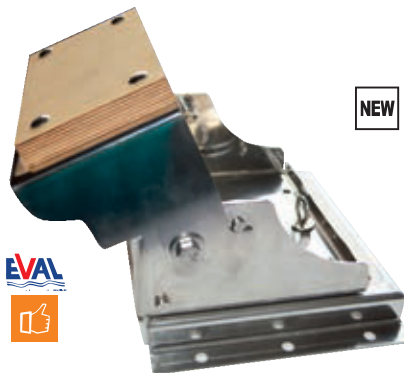

NEW

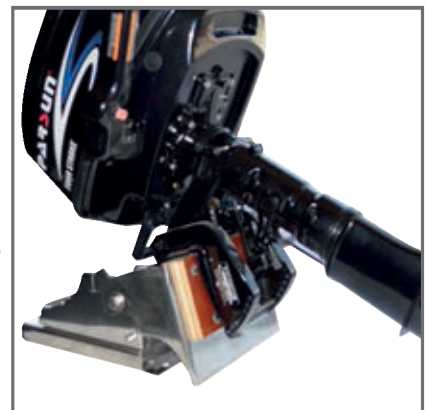

**BRACKET FOR AUXILIARY OUTBOARD MOTOR**  
Adjustable. Made of anodised aluminium, with wooden surface.

Code	OutBoard Weight kg	Dimensions cm
602	40	L 22 x W 13,5



### BRACKET FOR AUXILIARY OUTBOARD MOTOR

Adjustable. Made of stainless steel, with wooden surface.

Code	OutBoard Weight kg	Dimensions cm
2310	40	L 14 x W 10,7
3327	60	L 14 x W 14,5

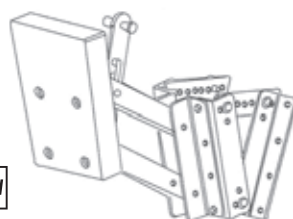

NEW

### Code 4381 ADJUSTABLE ANGLE BRACKETS

Very convenient and practical brackets for adjusting the outboards engine brackets in various angles.



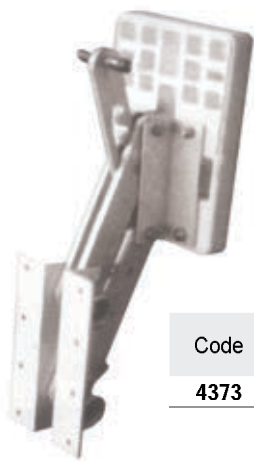

**BRACKET FOR AUXILIARY OUTBOARD MOTOR**  
Adjustable. Made of anodised aluminium, with plastic surface.

Code	OutBoard Weight kg	Dimensions cm
<b>4373</b>	40	L 22 x W 13,5



**REINFORCED BRACKET FOR AUXILIARY OUTBOARD MOTOR**  
Adjustable, made of stainless steel. With stainless steel springs and reinforced plastic surface.

Code	OutBoard Weight kg	Dimensions cm
<b>4375</b>	50	L 25,1 x W 13



**BRACKET FOR AUXILIARY OUTBOARD MOTOR**  
Adjustable. Made of stainless steel, with plastic surface.

Code	OutBoard Weight kg	Dimensions cm
<b>3144</b>	40	L 14 x W 10,7
<b>4374</b>	60	L 14 x W 14,5

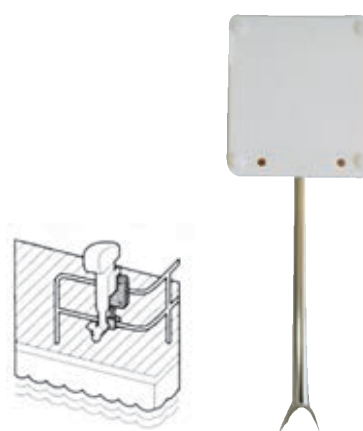

**BRACKET FOR OUTBOARD MOTOR**  
Made of plastic, with stainless steel pipe. Suitable for rail mounting, perfect for sailing boats.

Code	For tube Diameter mm	OutBoard Weight kg
<b>4372</b>	22 - 25	40



**BRACKETS FOR AUXILIARY OUTBOARD MOTOR**  
Adjustable made of stainless steel. Suitable for mounting on the transom pad.

Code	OutBoard Weight kg	Dimension scm
<b>3064</b>	40	L 23 x W 19,5 x H 26



**BRACKET FOR AUXILIARY OUTBOARD MOTOR**  
Fixed made of stainless steel. Suitable for mounting on the platform.

Code	OutBoard Weight kg	Dimensions cm
<b>607</b>	42	L 25 x W 20,5



**BRACKET FOR AUXILIARY OUTBOARD MOTOR**  
Made of stainless steel, with wooden surface.

Code	OutBoard Weight kg	Dimensions cm
<b>606</b>	40	L 26,5 x W 15



**SAFETY INOX CABLE FOR AUXILIARY OUTBOARD MOTOR BRACKETS**  
With stainless steel snap hooks.

Code	Length cm
<b>4376</b>	60



### FIXED ALUMINIUM OUTBOARD MOTOR EXTENSION HANDLE

It is made of anodised aluminum tube Ø25mm

Code	Length cm
647	60

### ADJUSTABLE ALUMINIUM OUTBOARD MOTOR EXTENSION HANDLE

It is made of anodised aluminum tube Ø30mm and Ø25mm

Code	Length cm
646	82,5 - 135



Code 903  
PLASTIC MECHANISM  
OF MOTOR EXTENSION  
HANDLE  
It fits with tube Ø25mm



Code 1144 - 30  
PADLOCK FOR  
CODE 2275-2276.

### ALUMINIUM OUTBOARD EXTENSION HANDLE WITH SWIVEL LOCK

Lightweight, with stainless steel hardware.  
Can be used as a straight steering unit or  
swivel while trolling.

Code	Length cm
4390	76 - 119



Code 1144 - 1  
PADLOCK FOR  
CODE 2277.



3329 - 1  
3329 - 2



3329 - 3

### "POWERLOCKS" FOR OUTBOARD ENGINES LOCK

Heavy duty, made of stainless steel. With clamp screws.

Code	Type cm
3329 - 1	Up to 10 Hp
3329 - 2	10 - 30 Hp
3329 - 3	Up to 30 Hp



OUTBOARD  
ENGINE LOCK  
Stainless steel.

Code	Dimensions cm
2275	L 24,5 x W 3,5
2276	L 32,5 x W 3,5



OUTBOARD  
ENGINE LOCK  
Stainless steel. Suitable for  
all engines.

Code	Dimensions cm
2277	L 32,5 x Ø 4cm

**EVAL OUTBOARD TRANSOM PADS**

EVAL Outboard Transom Pads are made of rigid, UV stabilized, polypropylene with a new non-slip surface for secure engine mounting. By mounting EVAL Outboard Transom Pads to a transom it is achieved a better protection against outboard clamp damage and also the observation of engine's vibration. The new EVAL Outboard Transom Pads are suitable for all type of boats, with big or small transom, while one of them is "inclined". They are available in white color.



**OUTBOARD  
TRANSOME PAD (INCLINED)**

Code	Thickness mm	Dimensions mm
<b>3154</b>	5 / 20	L 445 x W 363



**OUTBOARD  
TRANSOME PAD**

Code	Thickness mm	Dimensions mm
<b>3155</b>	6	L 445 x W 363



**OUTBOARD  
TRANSOME PAD**

Code	Thickness mm	Dimensions mm
<b>3156</b>	6	L 316 x W 212



**OUTBOARD  
TRANSOME PAD**

Code	Thickness mm	Dimensions mm
<b>3157 - 1</b>	5	L 270 x W 100
<b>3157 - 2</b>	5	L 227 x W 87



**OUTBOARD TRANSOM PAD**  
Outboard transom pad, made of reinforced plastic with very high elasticity. Suitable for protecting the boat transom when mounting the outboard engine

Code	Thickness mm	Dimensions mm
<b>3863</b>	5	L 400 x W 280



**ALUMINUM OUTBOARD  
TRANSOME PAD**

Code	Dimensions mm
<b>608 - 1</b>	L 300 x W 95

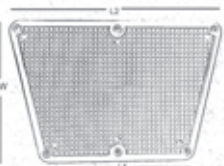
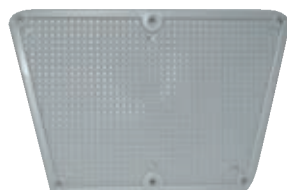

**PLASTIC TRANSOME PAD FOR OUTBOARD  
ENGINES**

Code	Thickness mm	Dimensions mm
<b>2199-34</b>	7	L1 192 x L2 265 x W 175



**ANODISED ALUMINUM OUTBOARD  
TRANSOME PAD**

Code	Dimensions cm
<b>4636</b>	A 38,1 x B 5,08 x C 33,02



**MOTOR WASHER FOR ENGINES**

Code	Length cm
776 - 30	30
776 - 34	34



**Code 2942**

**RECTANGULAR  
MOTOR WASHER  
FOR ENGINES**



**Code 798**

**MOTOR WASHER FOR  
OUTBOARD MOTORS,  
PROFESSIONAL**



**Code 3911**

**RECTANGULAR  
MOTOR WASHER FOR  
OUTBOARD MOTORS,  
PROFESSIONAL**

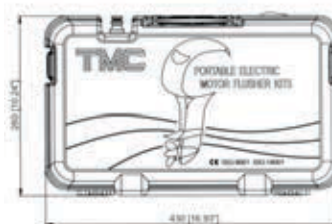

**PORTABLE ELECTRIC OUTBOARD MOTOR FLUSHER**

Provides maximum water flow , allowing to flush away sand, dirt , silt and alkali quickly and effectively with a hose to prevent clogging and corrosion. Portable feature makes the engine flush easy, no confinement for space or water supply.

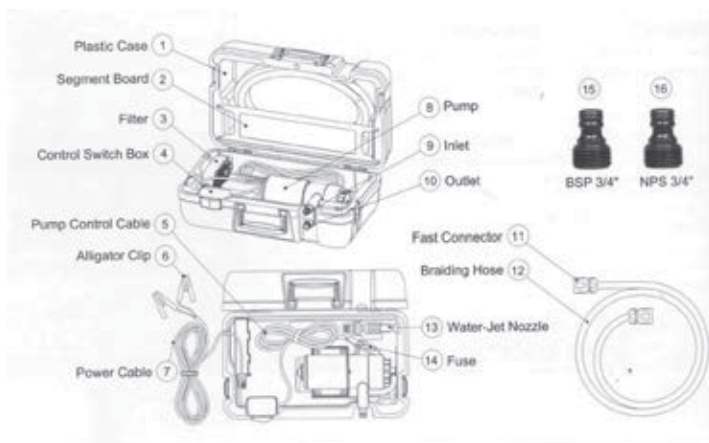

Code	Flow Rate lt/min	Supply	Connection Ø / mm	Delivery Head m
4545	25	12 V	19.05	10



Code 3334

**FOLDABLE OUTBOARD ENGINE  
TROLLEY**

Ergonomic design. Easy to move and store. Weighs less than 6 kg and can carry outboards up to 15hp.



**Code 595**  
**FOLDING ENGINE TROLLEY**  
**FOR ENGINES UP TO 60 KG**  
Galvanized.  
Easy for storage.

Code	Dimensions cm		
	A	B	C
595	96	40	90

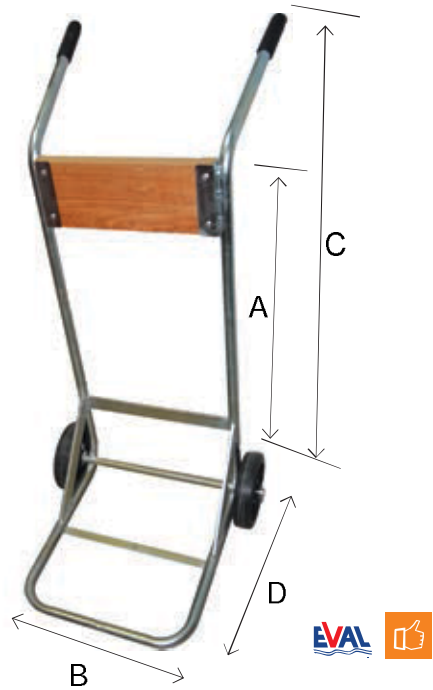

**TROLLEY FOR OUTBOARD ENGINES UP TO 60 KG**  
Galvanized

Code	Dimensions cm			
	A	B	C	D
3108	96,5	44	125	58

### HEAVY DUTY FLANGEMOUNT BLOWER

Heavy duty blower, made of reinforced thermoset plastic and corrosion-resistant materials. It is designed to remove fumes from the engine compartments prior to boat start up and suitable for applications such as commercial or high use engine room ventilation and extraction. It is of a radial design that offers the highest output in more complex installations with longer ducting lengths and/or multiple bends in the ducting. It is generally mounted directly onto a flat bulkhead using a mounting collar to connect to the discharge ducting. ISO 8846 for Ignition Protection, N.M.M.A. Type Accepted complies with ISO 9097 Marine, CE Conforms with EN 5008-1 Meets USCG Electrical Regulations Tough

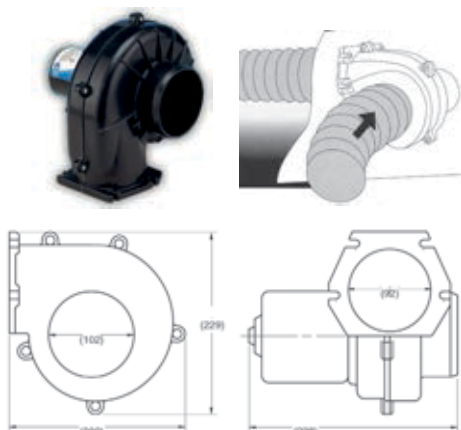

Code	Air Flow	Volt	Amp	Connection Ø mm	Weight
<b>948</b>	7.1 m3/min	12V	15	100	2,7 Kg

### HEAVY DUTY FLEXMOUNT BLOWER

Heavy duty blower, made of reinforced thermoset plastic and corrosion-resistant materials. It is designed to remove fumes from the engine compartments prior to boat start up and suitable for applications such as commercial or high use engine room ventilation and extraction. It is of a radial design that offers the highest output in more complex installations with longer ducting lengths and/or multiple bends in the ducting. It is installed by attaching a mounting collar around the motor (which is supplied with the blower) to any convenient solid surface. With flex mounting for 360° adjustable outlet. ISO 8846 for Ignition Protection, N.M.M.A. Type Accepted complies with ISO 9097 Marine, CE Conforms with EN 5008-1 Meets USCG Electrical Regulations Tough

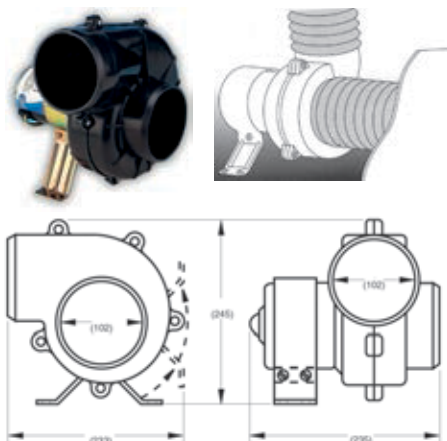

Code	Air Flow	Volt	Amp	Connection Ø mm	Weight
<b>950</b>	7.1 m3/min	12V	15	100	3,2 Kg

MOTOR EQUIPMENT

### HYDROFOILS

Suitable for outboard and stern drive motors

- o Reduced fuel consumption
- o Reduced planning time
- o Stops bow rise
- o Reduce cavitation, increase stability



Code 544

UP TO 50 hp



Code 644

OVER 40 hp

The hydrofoil suits to 40HP up to 225HP engine.



**SMART TABS**

SMART TABS incorporate fully automatic features in addition to the rust and corrosion free benefits of molded composite materials. They provide un-equalled performance and durability with no maintenance in fresh or salt water. The system can be specifically tuned to maximize the performance of any power boat, and TRACKING RIBS have been added to improve handling at higher speeds. The patented SMART TABS are a one of a kind trim and stabilizer system that automatically adjusts to the sea conditions, without the need for expensive electric or hydraulic hardware and switches. The system constantly reacts to the water conditions, boat speed, and balance providing a remarkable improvement on any boat.

**Smart Tabs Benefits :**

- Promotes Planing
- Improves Fuel economy
- Reduces Bow Rise
- Fully Automatic and Active
- Corrosion Free Composite Design
- Easy Installation
- Suitable for all types of boats



code	Boat length meters	Horse Power HP	Type	Actuator pres- sure weight kg	(Tab Material)	Trim Plates size cm
1764-1	3,00 – 3,65	8 – 15HP	2-STROKE	9	STAINLESS STEEL 316	17,80 x 20,30
1764-2		20 – 25HP	4-STROKE	13	STAINLESS STEEL 316	
1761-1	4,00 - 4,50	25 - 40HP	2-STROKE	13.60	HIGH QUALITY ABS PLASTIC	24,10 x 25,40
1761-2	3,65 – 4,30	30 – 50HP	4-STROKE	18		
	4,30 – 4,90	40 – 80HP	2-STROKE			
1761-3	4,60 – 5,20+	50 – 100HP	4-STROKE	27		
	4,90 – 5,50+	60 – 150HP	2-STROKE			
1761-4	5,50 – 6,70	150 – 240HP	2-STROKE 4-STROKE	36		
1761-5	6,40 – 7,60	175 - 220HP 150 – 190HP 4 H 6 CYLINDERS	2-STROKE 4-STROKE IN/OUT	32		
1761-6	6,40 – 7,60	220 – 250HP 200 – 250HP 8 CYLINDERS	2-STROKE 4-STROKE IN/OUT	41		

**SPARE GAS ACTUATORS  
In BLISTER pack.**

Codeç	Description	Type
1808-1	GAS ACTUATOR 41 Kg	Single
1808-2	GAS ACTUATOR 36 Kg	
1808-3	GAS ACTUATOR 31 Kg	
1808-4	GAS ACTUATOR 27 Kg	
1808-5	GAS ACTUATOR 18 Kg	
1808-6	GAS ACTUATOR 13,60 Kg	
1808-7	GAS ACTUATOR 9 Kg	

**Code 1762-1****ELECTRIC TRIM TABS SET**

The electric trim tabs set offers up to 40% more stability and reliability during navigation for boats of 4,5 up to 6 meters. Furthermore much better fuel saving is achieved. Easy installation.

The trim tabs set includes :

- 1 pair of trim tab of single actuator. Size : L310mm x W220mm(12" X 9")
  - 1 Switch panel that controls and adjusts the pair of trim tab. Each trim tab has 6 - position indicator with 6 LED signal-light.
- Size : L 99,5 mm x W 71,5 mm
- 1 Wire harness

**Code 1762-2****MANUAL TRIM TABS SET**

The set of manual trim tabs is a cost-effective solution for small boats. They offer more stability and reliability during navigation for boats of 4,5 up to 6 meters. Furthermore much better fuel saving is achieved and easy installation as no wiring is required. This trim tab can be stretched 60 mm max. Navigation is achieved by manually changing and regulating the Strut according to sea turbulence, the boat loading, the number of passengers etc

The trim tab set includes :

- 1 pair of trim tab with manual adjustable strut and stainless steel pole
- Tab panel with size L305mm x W235mm (12" x 9")





Code	Length cm	Type
4961	Adjustable from 50 cm to 80 cm	Up to 150 HP

#### MOTOR SUPPORT BRACKET UP TO 150HP

Suitable for lifting the outboard engine when the boat is loaded on a trailer or on a cradle; adjustable universal size, fits any model; the peg support is made of rubber and fitted with mounting straps.



#### BOW THRUSTERS

XFORCE Bow Thrusters are presented for the first time in the Greek market. They are characterized by high efficiency and robust construction and they have undergone several laboratory and sea-environment tests. They form a complete system that allows maneuvering for a better handling of the vessel in navigation and mooring. The mechanism is placed alongside the tunnels achieving small system volume while reducing noise and making XFORCE suitable for both large and small vessels. All XFORCE systems are equipped with control units that are not affected by variations in voltage and protect against high temperatures, thus reducing the chances of failure.

4387 - 03 -0514

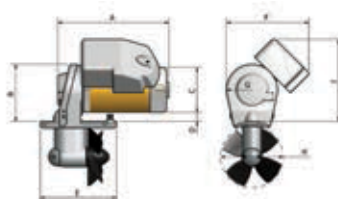

4387 - 03 - 05

Code	Placement	Voltage V	Boat Length m	Power kw/hp	Weight kg	Tunnel Diameter mm	Propellers	Thrust kg	Transmissions
4387-03	Bow	12	11,7	5 / 6,8	16	160	1	60	Belt
4387-05	Bow	12	16,5	6,5 / 8,8	18	185	1	90	Belt

#### Dimensions mm

Code	A	B	B1	B2	C	D	E	F	G	H
4387 - 03	310	150			130	15	192	210	65,5	160
4387 - 05	310	190			130	50	200	210	75	185



**Additional necessary equipment for thruster function:**

Main Battery Switch, Fuse, Fuse Holder, Tunnel, Touch Panel and 10m Cable, if a Joystick Panel is used.

**Code 4388-02**  
**BATTERY SWITCH**

**Code 4389-01 , 4389-10**  
**TUNNEL**

**Code 4388-03**  
**FUSE HOLDER**

**Code 4388-04**
**XFORCE TOUCH PANEL**

Stationary control switch, waterproof after appropriate placement. It can be placed on surfaces that are slightly curved. Available with 10 m cable.

**Code 4388-06**
**XFORCE DOUBLE JOYSTICK PANEL**

Double switch joystick controller. It is waterproof, unaffected by ultraviolet radiation and has on / off switch and indicator light operation.

**Code 4388-05**
**XFORCE SINGLE JOYSTICK PANEL**

Single switch joystick controller. It is waterproof, unaffected by ultraviolet radiation and has on / off switch and indicator light operation.

Code	Dimensions		"Compatible Thrusters code"
	Diameter mm	Length m	
<b>4389-01</b>	185	1	4387-13, 4387-14, 4387-05, 4387-06
<b>4389-02</b>	185	1.5	4387-13, 4387-14, 4387-05, 4387-06
<b>4389-10</b>	160	1	4387-02, 4387-03, 4387-04
<b>4389-11</b>	160	1.5	4387-02, 4387-03, 4387-04

**ADDITIONAL NECESSARY EQUIPMENT CODES**

Code	Battery Switch	Fuse	Fuse Holder	Tunnel	Panel	Cable
<b>4387 - 03</b>	4388 - 02	4388 - 09	4388 - 03	4389 - 10	Πάνελ 4388 - 04	Διατίθεται ενσωματωμένο
<b>4387 - 05</b>	4388 - 02	4388 - 10	4388 - 03	4389 - 01	Πάνελ 4388 - 04	

**Remarks:**

- 1) All thrusters are equipped with on board wireless main control unit capable of working together with the wireless remote control (code 4388-16).
- 2) Optionally, code 4388-04 (Touch panel) can be replaced by code 4388-05 (Single joystick panel) for thrusters with codes 4387-01-02-03-04-05-06-13-14.
- 3) Optionally, code 4388-05 (Single joystick panel) can be replaced by code 4388-06 (Double joystick panel) for thrusters with codes 4387-07-08-09-10-11, only if the boat is equipped with both bow and stern thruster.
- 4) Optionally, codes 4388-05 and 4388-06 (Single and Double joystick panel) can be replaced by code 4388-16 (Wireless remote control).
- 5) Code 4389-13 (Cable) is necessary for the function of codes 4388-05 and 4388-06 (Single and Double joystick panel).
- 6) The battery cables and polyester, are not included in the XFORCE accessories.



## HIGH PERFORMANCE PROPELLERS

The high performance Turning Point Propellers are available in stainless steel and aluminum for all types and brand engines. Specially designed propeller blades maximize top speed, acceleration and grip on the water. They are consisted of the main propeller and the hub kit. This is a great advantage because for a single engine it is possible to fit more than one propellers of different pitch with the same hub kit. In case of hub kit damage, it can be replaced without replacing the propeller itself.

- Fuel efficient. Low slip designs.
- Fast. New state-of-the-art blade geometry.
- Impressive in handling and edge hold. Advanced pitch & rake line cupping with the latest edge designs.
- Incredible in hole shot performance. The only ventilated aluminum propellers in the market.
- Durable. Unique squeeze casting process produces strongest blades with fine grain and no internal voids.
- Corrosion and impact resistant. Ultra Coat Finish New Five Step Powder Coating Process.
- Lifetime Warranty Hub Kits

## MasterGuard<sup>®</sup> Hub Kit System

The Masterguard Hub System is the most durable and simplest hub system available. Utilizing a triple tapered key and keyway system, the Masterguard Hub leaves no chance for error. This premium hub system adapts to Turning Point's Rascal, Hustler, Express, Speedzone and Classic propeller lines.



High performance aluminum propellers for 90 – 300+ hp, 3-blade, 4-blade, left rotation and right rotation suitable for all water activities.

Hustler are the only aluminum propellers manufactured with performance enhancing vent holes. Incorporating the newest and efficient design features based on high-performance stainless steel propellers, Hustler are unmatched in cornering, acceleration, boat handling, and top speed.



Best value for money stainless steel propellers for 9,9-300+hp, 3-blade, 4-blade left rotation and right rotation.

Express stainless steel boat propellers define what a true high performance stainless prop should be. Express gives maximum overall performance boaters demand from a stainless steel propeller – Fast top end, quick acceleration and great holding ability. The best value of any stainless prop!



## SELECTING THE PROPER PROPELLERS

Selecting the proper propeller, we usually mean choosing the correct pitch. The general rule is that the engine raises the maximum speed with the usual loads on the boat and at full throttle. If unable to catch the limits, then you usually have to lower the pitch, while in the case that exceeds (raises more turns), you must upgrade pitch. However, if you use your boat for different purposes, e.g. for tourism and water sports attraction, and you are very close to the limits of the engine, it is better to have two different pitch propellers, suitable for every occasion. The general rule therefore, in choosing the right pitch propeller, is the engine to raise the maximum speed while having the normal load on board. Regarding the choice of the propeller type depends on the combination of engine - boat and use of the boat.

The impact of selecting the wrong propeller are as follows : when an engine fails to catch limits when operating with extended throttle open, this means that it operates in high torque, which results in "overloading" piston and the crank of the springs. Furthermore, the motor works at higher temperatures with the danger of overheating due to knock the poorest mixture. It is as if trying to start your car uphill with a third speed gear. If the opposite happens, the engine raises more turns than the upper limit and the damage caused will be greater incorporating the risk of breaking some parts and pieces of them to pass to the big cylinders area.

The propeller pitch (Pitch), usually measured in inches (1" = 2.54cm), is the distance traveled by the propeller in the water in a full rotation. For example, a propeller with Step 19" in a complete rotation of the water travels through 48.26cm (19X 2.54). Choosing the right pitch is a combination of the maximum speed (knots) we want to achieve, the relationship of reduction in the engine foot, and the maximum payload speed limit. In the formula below gives this relationship:

$$\text{Pitch} = (\text{Knts}) \times (\text{RR}) \times (1350) / (\text{RPM})$$

wherein:

**Pitch** = the required pitch of the propeller in inches.

**Knts** = the maximum speed you want to achieve in nautical miles per hour.

**RR** = the relative reduction of the engine foot.

**RPM** = the maximum load limit of the engine

For example, if an hypothetical boat requires 135 HP to run at 40 knots the effective limit engine speed, we choose an engine of 140 HP, with a reduction ratio in the engine foot of 2.38 and maximum effective speed limit at 6200 RPM, then the right step is calculated as follows :

$$\text{Pitch} = 40 \times 2.38 \times 1350 / 6200 = 20.73" \text{ or } 21"$$

## Diameter

Propeller diameter is the diameter of the circle forming the blades when rotated. The diameter are relatively indifferent when selecting propeller.

## 3-blade or 4-blade

Briefly a 3-blade propeller offers high speeds, while a 4-blade provides smoother sailing . If we want higher speeds with fewer rotation we mainly use 4-blade propellers.

## Construction Material

The most common propellers are aluminum and stainless steel. The aluminum propellers are the most widely used in motor boats. They are cost effective, while performing well . Stainless steel propellers are five times stronger than aluminum ones. They are much more resistant to corrosion with no power loss.

## How to find your boat propeller: 25 – 75HP Propellers with 3-1/2" gearcase

ENGINE BRAND 13 spline PROP shaft	HUB Code	PROPELLER CATEGORY
EVINRUDE® /JOHN- SON®: 4-stroke : 40hp, 50hp	1946 – 11	
FORCE®: 40hp ('95-'98), 50hp ('95- '98), 70hp ('91-'95), 75hp ( '96-'98)		
HONDA®: BF 4-stroke : 35, 40, 45, 50, 60hp, (not P60)	1946 – 12	
MERCURY® & MARINER®: Διχρονη: 30hp ('94+) / 35, 45, 55 / 40, 50, 60 ('77+) / 70hp ('83-) 4-stroke : 25hp Bigfoot /30hp ( '94-'05) / 40hp to 60hp	1946 - 11	

ALUMINUM PROPELLERS	
CODE	DIAMETER X PITCH
1950-1208	12-1/2 X 8
1950-1210	12 X 10-1/2
1950-1011	10-7/8 X 11
1950-1012	10-3/4 X 12
1950-1013	10-1/2 X 13
1950-1014	10-3/8 X 14
1950-1015	10-1/8 X 15

### 1.Engine

Find your engine manufacturer ,the horse power hp, the model and the date

### 2. Hub Kit

Select from the column HUB code the necessary hub kit for fitting the propeller .

### 3.Propeller category

In the column PROPELLER CATEGORY there are some shapes with or without numbers that give guidance to finding the proper propellers.

### EXPLANATION MARKS

#### 3-blade



#### Right Rotation (standard)



#### 4-blade



#### Left rotation



#### Hub categories for propellers

8 - 20hp with 2-1/2" gearcase	★
9.9 - 35hp with 3" gearcase	▲
25 - 75hp with 3-1/2" gearcase	●
40 - 150hp with 4-1/4" gearcase	◆
90 - 300+hp with 4-3/4" gearcase	■



## 8 – 20HP Aluminum Propellers with 2-1/2" gearcase

ENGINE BRAND – Various spline PROP shaftsT	HUB Cod	PROPELLER CATEGORY
EVINRUDE® /JOHNSON®: (13 spline) <b>2-stroke</b> ('74-'95): 9.9, 15 <b>4-stroke</b> : 8hp ('96+), 9.9hp ('95-'01), 15hp ('95+)	1946 - 202	
EVINRUDE® /JOHNSON®: (10 spline ) <b>4-stroke</b> ('02+):9.9,15hp	1946 - 206	
HONDA®: (8 spline) 8hp ('01+) / 9.9, 15, 20hp. Does not fit 8 Classic, pin drive	1946 - 205	
MERCURY® &MARINER®: (8 spline, lock nut) <b>2-stroke</b> : 6hp, 8hp, 9.9hp, 15hp / Sea Pro/Marathon 10hp, 15hp <b>4-stroke</b> : 8hp, 9.9hp ('95-'04), 15hp ( '89-'06)	1946 - 201	
MERCURY® &MARINER®: (14 spline shaft by Nissan,cotter pin) <b>4-stroke</b> : Bigfoot ('05+):8hp, 9.9hp <b>4-stroke</b> : ('07+): 15hp	1946 - 207	
NISSAN® & TOHATSU®: (14 spline ) <b>2-stroke</b> : 9.9hp ('84-'05), 12hp ('85-'88) / 15 & 18hp ('85-'05) <b>4-stroke</b> : 9.9hp, 15hp, 18hp, 20hp		
PARSUN®: (8 spline ) 9.9hp, 15hp	1946 - 205	
SUZUKI®: (10 spline Type M) DT <b>2-stroke</b> : 9.9 ('83-'87), 15hp, 15C/ DF <b>4-stroke</b> : 8A, 9.9A, 9.9, 15 / ('12+): 15A, 20A Does not fit with:DT8C & 9.9C('88-'97)	1946 - 206	
YAMAHA®: (8 spline ) <b>2-stroke</b> : 9.9, 15 / <b>4-stroke</b> : 9.9, 15, 15C, 20hp	1946 - 205	



### ALUMINUM PROPELLERS

CODE	DIAMETER X PITCH
1955-0909	9 X 9
1955-0910	9 X 10

MOTOR EQUIPMENT



ENGINE BRAND – 12 spline PROP shaft	HUB Code	PROPELLER CATEGORY
NISSAN® & TOHATSU®: (12 spline) 2-stroke & 4-stroke: 8hp, 9.8hp	1946 - 208	
MERCURY® & MARINER®: (12 spline cotter pin) 4-stroke: ('05 & newer): 8hp, 9.9hp		

### ALUMINUM PROPELLERS

CODE	DIAMETER X PITCH
1956-0909	9 X 9
1956-0910	9 X 10

## 9.9 – 35HP Propellers with 3" gearcase

ENGINE BRAND	HUB Code	PROPELLER CATEGORY
<b>EVINRUDE® /JOHNSON®:</b> (14 spline ) 2-stroke: 20, 25 ('84+), 25 commercial ('93-'05), 30 ('84+), 35 ('76-'05) / E-Tec: 25hp, 30hp / H.O.: 15hp	1946 - 22	
<b>FORCE®:</b> (10 spline ) 25hp ('95-'98)		
<b>MERCURY® &amp;MARINER®:</b> (10 spline ) 2-stroke : 18hp ('80-'85), 20hp ('86& newer ), 25hp ('85& newer ) 4-stroke: Bigfoot: 9.9hp, 15hp	1946 - 21	



### ALUMINUM PROPELLERS

CODE	DIAMETER X PITCH
1947-1011	10-1/2 X 11
1947-1013	10-1/8 X 13

### STAINLESS STEEL PROPELLERS

CODE	DIAMETER X PITCH
1964-1010	10-1/8 X 10
1964-1011	10-1/8 X 11
1964-1012	10-1/8 X 12
1964-1013	10-1/8 X 13
1964-1014	10-1/8 X 14
1964-1015	10-1/8 X 15

ENGINE BRAND	HUB Code	PROPELLER CATEGORY
<b>HONDA® :</b> BF25, BF30	1946 - 28	
<b>MERCURY® &amp;MARI-NER®:</b> <b>4-stroke:</b> ('06 &newer, cotter pin shaft) 25hp , 30hp		
<b>PARSUN®:</b> 20hp, 25hp	1946 - 25	
<b>NISSAN® &amp; TOHATSU®:</b> 2-stroke & 4-stroke: 25hp, 30hp	1946 - 28	
<b>YAMAHA®:</b> 2-stroke : 20hp, 25hp, 30hp 4-stroke : 25hp	1946 - 25	

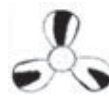

### ALUMINUM PROPELLERS

CODE	DIAMETER X PITCH
1948-1011	10-3/8 X 11
1948-1013	10-3/8 X 13

### STAINLESS STEEL PROPELLERS

CODE	DIAMETER X PITCH
1969-1010	10-1/8 X 10
1969-1011	10-1/8 X 11
1969-1012	10-1/8 X 12
1969-1013	10-1/8 X 13
1969-1014	10-1/8 X 14
1969-1015	10-1/8 X 15

ENGINE BRAND	HUB Code	PROPELLER CATEGORY
<b>EVINRUDE®/JOHNSON®:</b> 4-stroke : 25hp, 30hp	1946 - 26	
<b>SUZUKI®:</b> DT 2-stroke ('87& newer): 20, 25, 25C, 30, 30C DF 4-stroke : 25hp, 30hp		

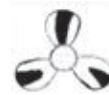

### ALUMINUM PROPELLERS

CODE	DIAMETER X PITCH
1957-1011	10-1/2 X 11
1957-1013	10-1/8 X 13

### STAINLESS STEEL PROPELLERS

CODE	DIAMETER X PITCH
1986-1010	10-1/8 X 10
1986-1011	10-1/8 X 11
1986-1012	10-1/8 X 12
1986-1013	10-1/8 X 13
1986-1014	10-1/8 X 14
1986-1015	10-1/8 X 15

## 25 – 75HP Propellers with 3-1/2" gearcase

ENGINE BRAND 13 spline PROP shaft	HUB Code	PROPELLER CATEGORY
EVINRUDE® / JOHNSON®: 4-stroke : 40hp, 50hp	1946 – 11	1
FORCE®: 40hp ('95-'98), 50hp ('95-'98), 70hp ('91-'95), 75hp ('96-'98)		
HONDA®: BF 4-stroke : 35, 40, 45, 50, 60hp, (not P60)	1946 – 12	
MERCURY® & MARINER®: 2-stroke: 30hp ('94+) / 35, 45, 55 / 40, 50, 60 ('77+) / 70hp ('83-) 4-stroke : 25hp Bigfoot / 30hp ('94-'05) / 40hp up to 60hp	1946 - 11	
NISSAN® & TOHATSU®: 40C, 40D, 50D, 50C, 60A, 70A2, 60B, 70B	1946 - 13	
PARSUN®: T30, T35, T36, T40	1946 – 12	
SUZUKI®: DT 2-stroke ('89+): 35C, 40, 50, 50M, 55, 60, 65hp DF 4-stroke : 40hp, 50hp / ('10+): 40A, 50A, 60A	1946 – 11	
YAMAHA®: 2-stroke : 40hp to 55hp 4-stroke : FT25hp High Thrust, 30hp up to 60hp	1946 – 12	



1



1



ALUMINUM PROPELLERS	
CODE	DIAMETER X PITCH
1950-1208	12-1/2 X 8
1950-1210	12 X 10-1/2
1950-1011	10-7/8 X 11
1950-1012	10-3/4 X 12
1950-1013	10-1/2 X 13
1950-1014	10-3/8 X 14
1950-1015	10-1/8 X 15

STAINLESS STEEL PROPELLERS	
CODE	DIAMETER X PITCH
1953-1209	12 X 9
1953-1211	12 X 11
1953-1213	12 X 13
1953-1011	10-1/2 X 11
1953-1012	10-1/2 X 12
1953-1013	10-1/2 X 13
1953-1014	10-1/2 X 14
1953-1015	10-1/2 X 15

MOTOR EQUIPMENT

ENGINE BRAND 13 spline PROP shaft	HUB Code	PROPELLER CATEGORY
EVINRUDE® / JOHNSON®: 2 cylinders : 40hp, 48hp/50hp ('75-'05) / 55hp ('76-'79) / 60hp, 65hp ('80-'85) 3 cylinders (with small gearcase): 75hp ('75-'85) Sprint and Formula E ('86-'92)	1946 - 12	2



2



2



ALUMINUM PROPELLERS	
CODE	DIAMETER X PITCH
1951-1208	12-1/2 X 8
1951-1210	12 X 10-1/2
1951-1213	12-1/2 X 13
1951-1215	12-1/4 X 15
1951-1117	11-3/4 X 17

STAINLESS STEEL PROPELLERS	
CODE	DIAMETER X PITCH
1954-1209	12 X 9
1954-1211	12 X 11
1954-1213	12 X 13
1954-1113	11-3/4 X 13
1954-1115	11-3/4 X 15
1954-1117	11-3/4 X 17

Nissan/Tohatsu: can't use H1-12xx and E1-12xx.

## 40 – 150HP Propellers with 4-1/4" gearcase

MOTOR EQUIPMENT

ENGINE BRAND – Various spline PROP shafts	HUB Code	PROPELLER CATEGORY
EVINRUDE® /JOHNSON®: (13 spline shaft ) <b>2 cylinders</b> : 50hp ('71-'74) / 45 to 55hp commercial <b>3 cylinders</b> : 55, 60, 65, 70hp, 75hp with large gearcase, 65hp commercial <b>4 cylinders</b> : 75, 85, 88, 90, 100, 110, 115, 120 ('86-'94), 125, 135 ('73-'76), 140 ('77-'84, '86-'94) / H.O.: 115hp E-TEC: 40, 50, 60, 75hp / 20" shaft: 90, 115hp, 130hp ('09-'10)	1946 - 503	
EVINRUDE® /JOHNSON®: (13 spline shaft ) <b>4-stroke</b> : 60hp, 70hp	1946 - 506	
FORCE® (15 spline shaft ): 75hp ('99) / 90hp up to 150hp ('95& newer)	1946-501	
HONDA® (15 spline shaft): P60 / 75hp, 90hp ('99+) / 115hp, 130hp. (not 115D)		
HONDA® (15 spline shaft): P60 / 75hp, 90hp ('99+) / 115hp, 130hp. (not 115D)	1946-507	
MERCURY® & MARINER® (15 spline shaft): <b>2-stroke &amp; 4-stroke:</b> 40 up to 60 Bigfoot / 70 ('87-'89) / 75, 80 ('78-'89), 90, 100, 115, 125, 140hp 150 XR4/6 (thru 1993,includes equivalent Mariner Magnum I, II,III.) OptiMax: 75, 90, 115, 125hp	1946-501	
NISSAN® & TOHATSU® (15 spline shaft): 60C, 70C / 90 up to 140hp	1946-505	
OMC® (13 spline shaft): Cobra 400: 2.3 to 3.0L ('78-'89)/Sea Drive:1.6 to 1.8L	1946-503	
PARSUN® (15 spline shaft): T60, T75, T85, T90	1946-500	
SUZUKI®: (13 spline shaft) DT <b>2-stroke</b> ('89+): 75 up to 140hp DF <b>4-stroke</b> : ('98-'09): 60hp, 70hp	1946-506	
YAMAHA® (15 spline shaft): High Thrust: T50, FT60 <b>2-stroke</b> : 60 up to 100hp <b>4-stroke</b> :70 up to 100hp	1946-500	
YAMAHA® (15 spline shaft): 2-stroke : 115 up to 130hp 4-stroke : 115hp	1946-505	



### ALUMINUM PROPELLERS

CODE	DIAMETER X PITCH
1961-1411	14 X 11
1961-1413	14 X 13
1961-1315	13-3/4 X 15
1961-1317	13-1/4 X 17
1961-1319	13-1/4 X 19
1961-1321	13-1/4 X 21
1961-1323	13-1/4 X 23



### ALUMINUM PROPELLERS 4-BLADE

CODE	DIAMETER X PITCH
1925-1315	13-1/2 X 15
1925-1317	13-1/4 X 17
1925-1319	13 X 19



### STAINLESS STEEL PROPELLERS

CODE	DIAMETER X PITCH
1966-1411	14 X 11
1966-1413	14 X 13
1966-1315	13-1/4 X 15
1966-1317	13-1/4 X 17
1966-1319	13-1/4 X 19
1966-1321	13-1/4 X 21



ENGINE BRAND 15 spline PROP shaft	HUB Code	PROPELLER CATEGORY
<b>SUZUKI® / JOHNSON®:</b> 4-stroke : ('09+) 70A, 80A, 90A, 70hp, 80hp / ('01+) 90hp, 100hp, 115hp	1946-509	
<b>SUZUKI® / JOHNSON®:</b> DF 4-stroke : 115A, 140hp	1946-501	

### STAINLESS STEEL PROPELLER LEFT ROTATION



CODE	DIAMETER X PITCH
1901-1417	14 X 17
1901-1419	14 X 19
1901-1421	14 X 21
1901-1423	14 X 23

### STAINLESS STEEL PROPELLER RIGHT ROTATION

CODE	DIAMETER X PITCH
1966-1417	14 X 17
1966-1419	14 X 19
1966-1421	14 X 21
1966-1423	14 X 23



## 90-300+HP Propellers with 4-3/4" gearcase

ENGINE BRAND 15 spline PROP shaft	HUB Code	PROPELLER CATEGORY
<b>EVINRUDE® /JOHNSON®:</b> V4 with V6 large gearcase: 100hp commercial, 120hp ('85), 130hp ('95-'96), 140hp ('85), Pleasure ('95& newer):115hp, 130hp / H.O.: 150, 200, 225, 250hp E-TEC: (25" shaft) 90hp, 115hp, 130hp ('09-'10) / 135hp to 300hp V6: 135hp to 250hp / V8: 250hp to 300hp	1946 – 502	
<b>HONDA®:</b> BF115D, BF135, BF150, BF200 ('02-'12), BF225 ('02-'12)	1946 – 507	
<b>HONDA®:</b> BF200A ('13 & after), BF225A ('13 & newer), BF250A ('12& newer)	1946-508	
<b>MERCURY® &amp; MARINER®*:</b> Note :Does not fit Pro XS. V6: 135 to 300hp Verado: 135 to 275hp. OptiMax: 150, 200, 250hp	1946-501	
<b>MERCURUISER®:</b> Alpha One and Bravo One ('83& newer)		
<b>OMC®:</b> Cobra 800: 3.0 to 7.5L King Cobra: 454, 502 Sea Drive: 2.0 to 4.0L	1946-502	
<b>SUZUKI®:</b> DT 2-stroke: 150hp to 225hp	1946-507	
<b>VOLVO® PENTA SX &amp; OMC            SXCOBRA:</b> (19 spline) ('94& newer): 3.0 to 8.2L. Not available for Volvo Duo- Prop or Aquamatic drives.	1946-504	
<b>YAMAHA®:</b> <b>2-stroke &amp; 4-stroke :</b> 150 to 250hp /stern drives 3.0 to 7.4L	1946-505	



### ALUMINUM PROPELLERS 4-BLADE LEFT ROTATION

CODE	DIAMETER X PITCH
1943-1415	15 X 15
1943-1417	14-1/2 X 17
1943-1419	14 X 19
1943-1421	14 X 21

### ALUMINUM PROPELLERS 4-BLADE RIGHT ROTATION

CODE	DIAMETER X PITCH
1942-1415	15 X 15
1942-1417	14-1/2 X 17
1942-1419	14 X 19
1942-1421	14 X 21



### ALUMINUM PROPELLERS

CODE	DIAMETER X PITCH
1960-1515	15-1/4 X 15
1960-1417	14-1/4 X 17
1960-1419	14-1/4 X 19
1960-1421	14-1/4 X 21
1960-1423	14-1/4 X 23

### STAINLESS STEEL PROPELLERS 4-BLADE RIGHT ROTATION

CODE	DIAMETER X PITCH
1965-1415-4	14 X 15
1965-1417-4	14 X 17
1965-1419-4	14 X 19
1965-1421-4	14 X 21
1965-1423-4	14 X 23



### STAINLESS STEEL PROPELLERS LEFT ROTATION

CODE	DIAMETER X PITCH
1965-1415-L	14-1/4 X 15
1965-1417-L	14-1/4 X 17
1965-1419-L	14-1/4 X 19
1965-1421-L	14-1/4 X 21
1965-1423-L	14-1/4 X 23

### STAINLESS STEEL PROPELLERS RIGHT ROTATION

CODE	DIAMETER X PITCH
1965-1415	14-1/4 X 15
1965-1417	14-1/4 X 17
1965-1419	14-1/4 X 19
1965-1421	14-1/4 X 21
1965-1423	14-1/4 X 23

## 135-300+ HP Large Diameter Stainless Steel Propellers with 4-3/4" gearcase

MOTOR EQUIPMENT

ENGINE BRAND 15 spline PROP shaft	HUB Code	PROPELLER CATEGORY
JJOHNSON® : 4-stroke : 200hp, 225hp Note : fits with the propeller code 1970-16** diameter 16"	1946-507	
SUZUKI®: DF 4-stroke : 150 to 300hp Note : fits with the propeller code 1970-16** diameter 16"		



STAINLESS STEEL PROPELLERS RIGHT ROTATION	
CODE	DIAMETER X PITCH
1970-1617	16 X 17
1970-1619	16 X 19
1970-1621	16 X 21
1970-1623	16 X 23



STAINLESS STEEL PROPELLERS LEFT ROTATION	
CODE	DIAMETER X PITCH
1970-1617-L	16 X 17
1970-1619-L	16 X 19
1970-1621-L	16 X 21
1970-1623-L	16 X 23



STAINLESS STEEL PROPELLERS LEFT ROTATION	
CODE	DIAMETER X PITCH
1970-1515-L	15 X 15
1970-1417-L	15 X 17
1970-1419-L	15 X 19
1970-1421-L	15 X 21



STAINLESS STEEL PROPELLERS RIGHT ROTATION	
CODE	DIAMETER X PITCH
1970-1515	15 X 15
1970-1417	15 X 17
1970-1419	15 X 19
1970-1421	15 X 21



STAINLESS STEEL PROPELLERS 4-BLADE LEFT ROTATION	
CODE	DIAMETER X PITCH
1970-1417-4L	14-1/2 X 17
1970-1419-4L	14-1/2 X 19
1970-1421-4L	14-1/2 X 21
1970-1423-4L	14-1/2 X 23
1970-1425-4L	14-1/2 X 25



STAINLESS STEEL PROPELLERS 4-BLADE RIGHT ROTATION	
CODE	DIAMETER X PITCH
1970-1417-4	14-1/2 X 17
1970-1419-4	14-1/2 X 19
1970-1421-4	14-1/2 X 21
1970-1423-4	14-1/2 X 23
1970-1425-4	14-1/2 X 25